



26 Hillside, Chedgrave

In Excess of £490,000

26 Hillside

Chedgrave, Norwich

Situated on a generous sized plot, with spacious accommodation presented at a high standard. Minors and Brady are thrilled to present to the market this five bedroom detached bungalow located in the peaceful village of Chedgrave. Boasting a high quality kitchen/diner, a beautiful conservatory with log burner, a master bedroom with ensuite, versatile rooms, a large brick weave driveway with garage and a sweeping laid to lawn garden.

Council Tax band: TBD

Tenure: Freehold

EPC Energy Efficiency Rating: D

EPC Environmental Impact Rating: E

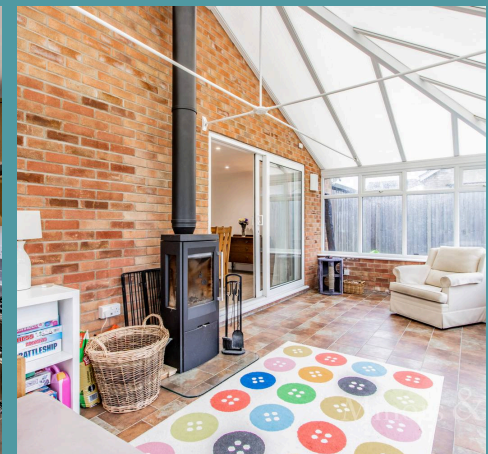



26 Hillside

Chedgrave, Norwich

Situated on a generous sized plot, with spacious accommodation presented at a high standard. Minors and Brady are thrilled to present to the market this five bedroom detached bungalow located in the peaceful village of Chedgrave. Boasting a high quality kitchen/diner, a beautiful conservatory with log burner, a master bedroom with ensuite, versatile rooms, a large brick weave driveway with garage and a sweeping laid to lawn garden.

LOCATION

Chedgrave offers a peaceful village lifestyle, the River Chet is positioned nearby with scenic countryside walks on your doorstep. The neighbouring market town of Loddon is within easy walking distance and offers a vast number of amenities along with local reputable schools. Norwich's City Centre is within easy reach along with Beccles Town Centre.

HILLSIDE

Upon entry into this welcoming home, you are greeted with a porch suitable for storing your outdoor wear before stepping into the bright and airy hallway. Entering the living room, filled with natural light, where you can unwind and relax after a long day. With ample amount of space for your comfortable free standing furniture. Following through into the heart of the home, this kitchen is an incredible part of the property and one that's sure to be a winner for today's lifestyles. Finished to a high standard, fitted with units and appliances to cook your favourite meals. Opening into the dining



GROUND FLOOR

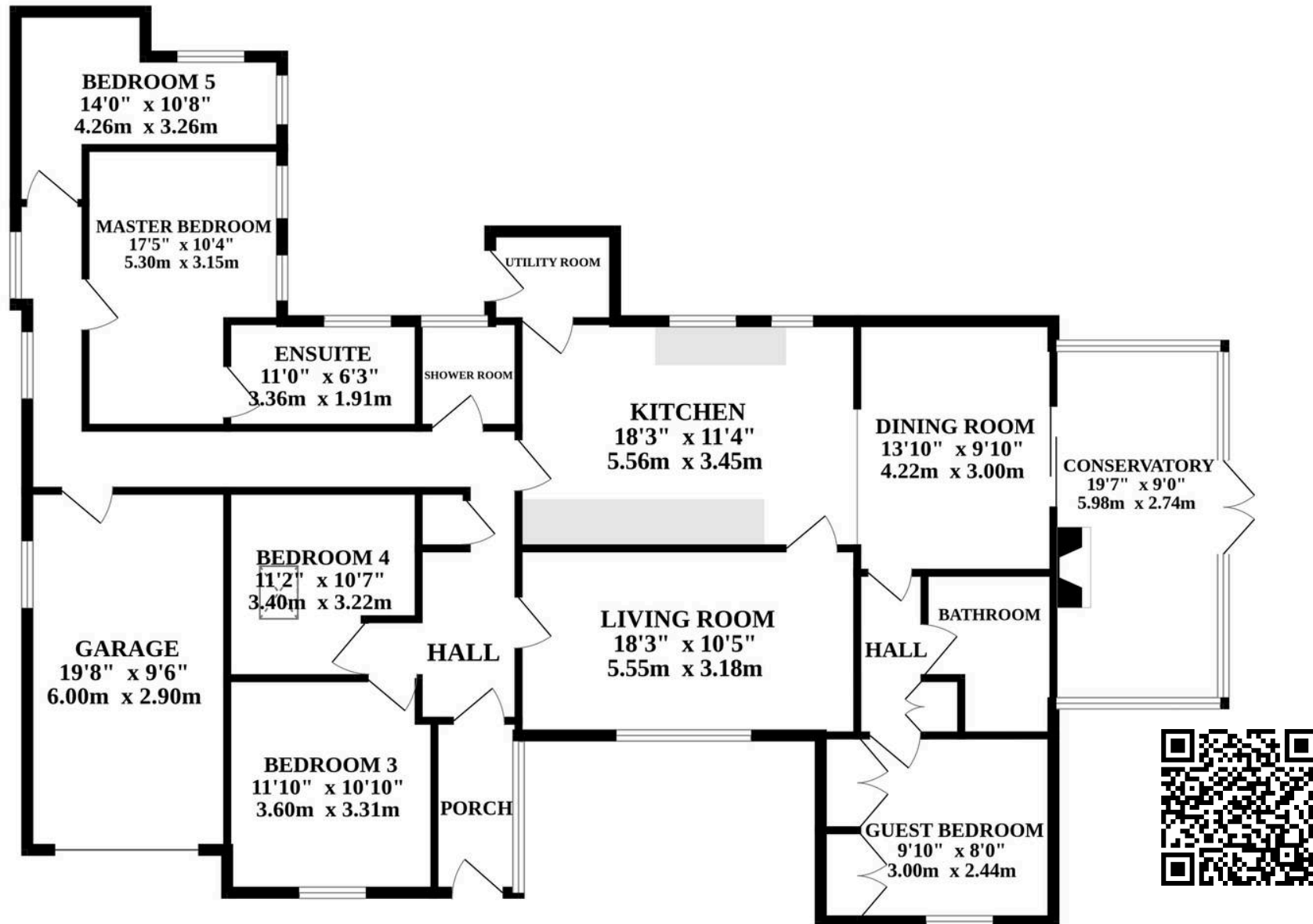

Whilst every attempt has been made to ensure the accuracy of the floorplan contained here, measurements of doors, windows, rooms and any other items are approximate and no responsibility is taken for any error, omission or mis-statement. This plan is for illustrative purposes only and should be used as such by any prospective purchaser. The services, systems and appliances shown have not been tested and no guarantee as to their operability or efficiency can be given.
Made with Metropix ©2023