



33 Wakefield Road, Norwich

33 Wakefield Road

Norwich, Norwich

TERRIFIC STUDENT PROPERTY - 4-bed mid-terraced student paradise 5 mins from UEA campus. Spacious kitchen, separate WC, fully furnished, generous rear garden. Prime location for ultimate university experience. Call to view.

Council Tax band: B

Tenure: Freehold

EPC Energy Efficiency Rating: C

EPC Environmental Impact Rating: C





33 Wakefield Road

Norwich, Norwich

TERRIFIC STUDENT PROPERTY - Welcome to the ultimate student paradise! This vibrant 4-bedroom mid-terraced property is not just your average student pad, it's a majestic kingdom of fun and learning. All bedrooms are great sizes! Perfectly situated a mere 5-minute walk from the UEA campus, you can practically roll out of bed and onto your first lecture - no need for those pesky alarms!

Step inside this student haven and you'll be greeted by a spacious kitchen-breakfast room that is perfect for whipping up all your favourite microwaveable meals. No need to worry about sharing one bathroom amongst four, because this gem comes with the convenience of a separate WC. And guess what? It's fully furnished! Say goodbye to awkwardly hauling your 17 boxes of belongings up four flights of stairs.

But wait, there's more! As if the interior wasn't enough to make your student heart skip a beat, this property boasts a generous rear garden. A verdant oasis in the midst of endless studies, where you can relax and soak up some much-needed vitamin D (while pretending to revise, of course). There is also a brick storage shed which is perfect for storing bikes or garden furniture.

In short, this property is the student's dream come true. With its prime location near the UEA campus, a spacious interior, and a garden to unwind in, you'll have the ultimate university experience. So don't wait, grab your textbooks and call us now to book this gem. You won't regret it!



GROUND FLOOR

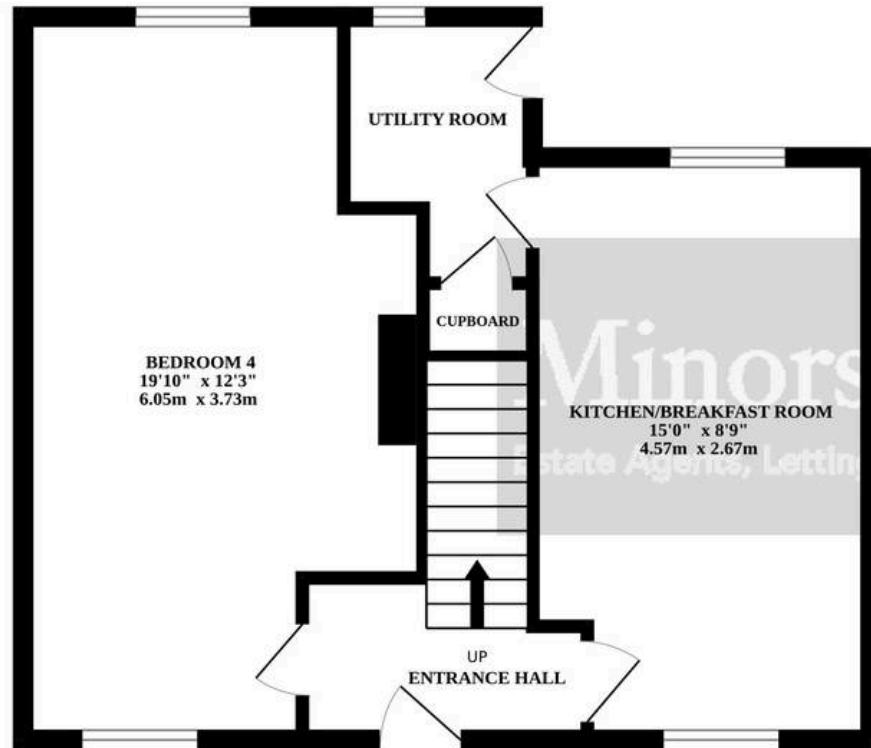

1ST FLOOR

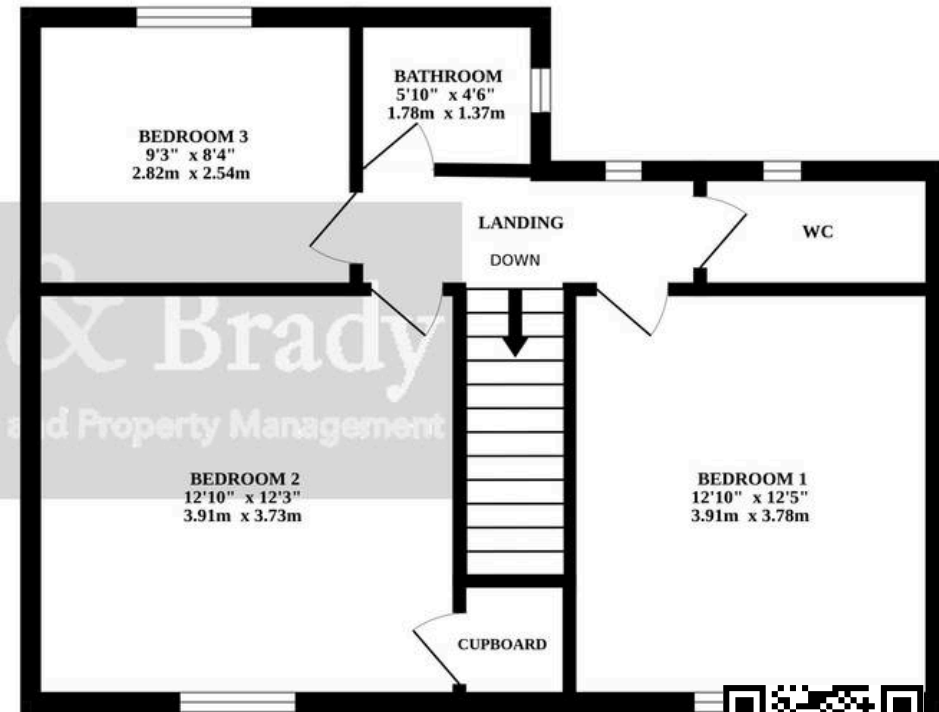

Whilst every attempt has been made to ensure the accuracy of the floorplan contained here, measurements of doors, windows, rooms and any other items are approximate and no responsibility is taken for any error, omission or mis-statement. This plan is for illustrative purposes only and should be used as such by any prospective purchaser. The services, systems and appliances shown have not been tested and no guarantee as to their operability or efficiency can be given.
Made with Metropix ©2024

