



Flat 20, Hardwick House King Street, Norwich

Offers In Excess Of £160,000 Leasehold

Luxurious one-bedroom apartment in prime location within the city centre. Currently generating £1,100pcm with an 8.2% yield, this is a fantastic opportunity for investors looking for a turn-key investment with the chance to purchase the property with tenants in situ. Providing a spacious double bedroom, open plan living with a contemporary kitchen and a stylish bathroom. Call the Norwich office for more information!

Nestled in the heart of Norwich, King Street is steeped in centuries of history. Lined with a harmonious blend of historic facades and modern establishments, it offers a unique tapestry of old-world charm and contemporary charisma. Meandering along King Street, you will find an array of boutique shops, artisanal eateries and vibrant cultural venues, all contributing to the dynamic pulse of this area. With the picturesque River Wensum flowing nearby, it's a delightful spot for leisurely strolls and enjoying the scenic views.



AGENTS NOTE

We understand the property will be sold leasehold and connected to mains water, electricity and drainage.

Council tax band - B.

Ground rent - £200 P/A.

Maintenance fee - £2,200 P/A.

Council Tax band: B



Nestled in a desirable location, this luxurious one-bedroom apartment presents a rare investment opportunity with a current yield of 8.2%. Artfully designed, open-plan living area bathed in natural light, the contemporary kitchen is well-equipped, with integrated appliances. The stylish bathroom adds a touch of elegance to the apartment.

The property offers a seamless transition for first-time buyers seeking a turn-key home, in a prime position within the city centre. For investors, the property currently generates £1,100pcm providing an 8.2% yield, with the added convenience of having the option of tenants in situ available. Situated in close proximity to the train station, offering easy access for daily commuting, residents can enjoy seamless connectivity to city amenities. Don't miss the chance to own this exquisite apartment, where modern living meets unrivalled convenience. Contact us today to schedule a viewing!



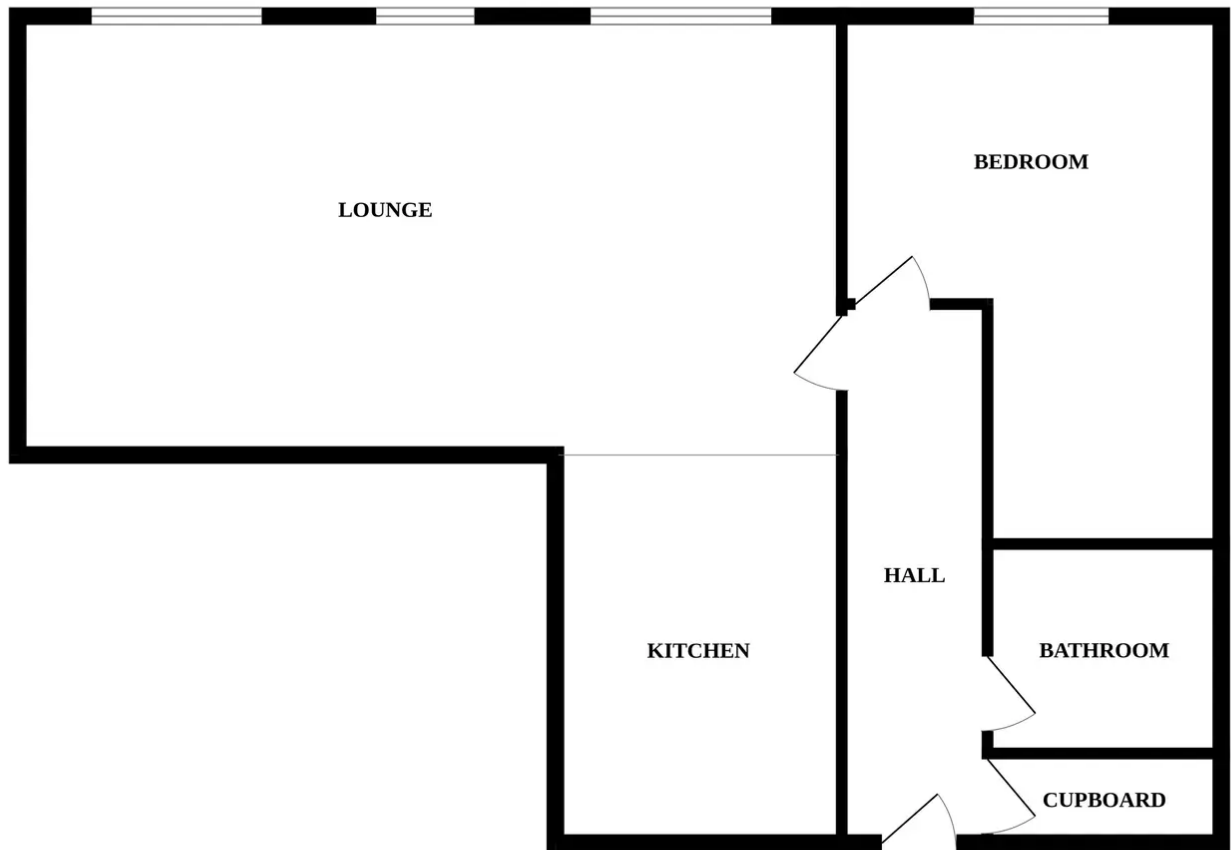

Whilst every attempt has been made to ensure the accuracy of the floorplan contained here, measurements of doors, windows, rooms and any other items are approximate and no responsibility is taken for any error, omission or mis-statement. This plan is for illustrative purposes only and should be used as such by any prospective purchaser. The services, systems and appliances shown have not been tested and no guarantee as to their operability or efficiency can be given.
Made with Metropix ©2024

