



Malnet Winfarthing Road, Banham

Offers In The Region Of £425,000

A spacious three-bedroom, detached bungalow in the tranquil village of Banham. Featuring spacious rooms, an ensuite, carport, garage, workshop, and a large south-facing garden. Enjoy a rural setting with modern amenities easily accessible. Call the Norwich office for more information!

Nestled in the picturesque countryside of Norfolk, Banham is a charming village renowned for its natural beauty and tranquil atmosphere. Located near the Norfolk/Suffolk border, Banham offers a delightful rural setting, perfect for those seeking a peaceful and idyllic lifestyle. Explore the quaint streets and discover the village's charming architecture, which includes thatched cottages, traditional farmhouses, and medieval churches. Despite its rural setting, Banham is well-connected and offers convenient access to amenities. The village features a range of local shops, country pubs, and eateries, catering to everyday needs.



AGENTS NOTE

We understand the property will be sold freehold and connected to mains electricity, water and drainage.

Council tax band - C.

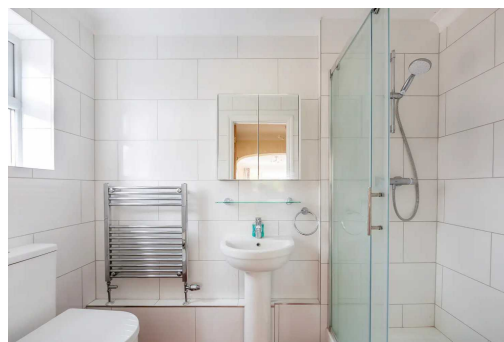

Nestled in a tranquil rural setting offering the perfect retreat, this welcoming three bedroom property presents a rare opportunity for those looking for a wealth of space inside and outside in a sought-after location. Boasting two reception rooms, ideal for entertaining or relaxing, and three generously sized bedrooms, this home offers space and comfort in abundance. The two reception rooms are versatile spaces and could be used as a study or dining room if required, one of the reception rooms boasts an exposed brick fireplace that adds a touch of character and warmth to the living space. The well-equipped kitchen with ample storage is the perfect space for preparing meals. The master bedroom features a luxurious ensuite bathroom and an attached dressing room, ensuring privacy and convenience.

For those with outdoor hobbies, the property features a carport, garage, and a handy workshop. The large south-facing garden bathes the property in natural light, adding to the charm and appeal of the home and is ideal for any keen gardener.

Conveniently located with easy access to Banham's amenities, this property offers a harmonious blend of rural tranquillity and modern convenience, making it a truly desirable place to call home.



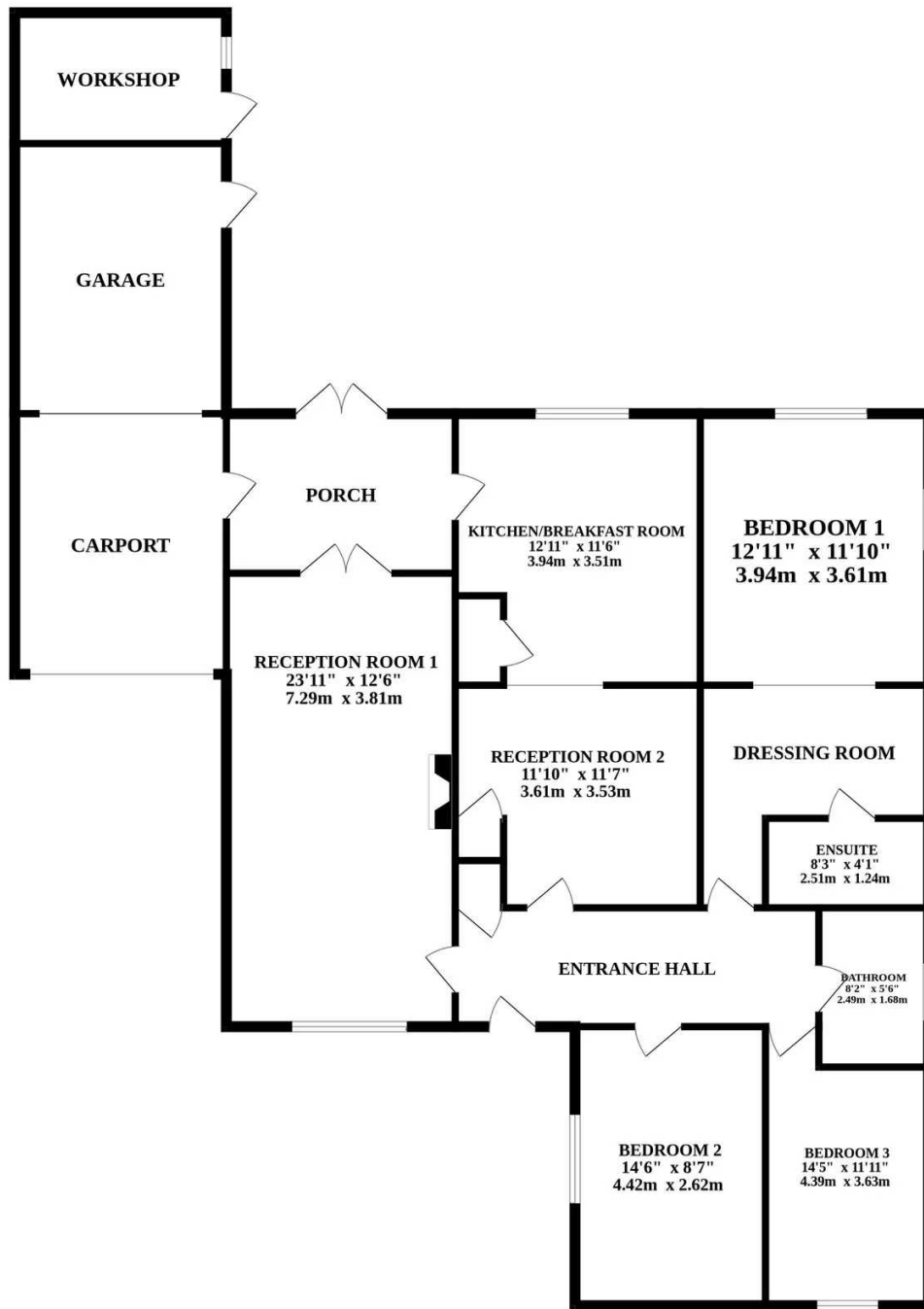

Whilst every attempt has been made to ensure the accuracy of the floorplan contained here, measurements of doors, windows, rooms and any other items are approximate and no responsibility is taken for any error, omission or mis-statement. This plan is for illustrative purposes only and should be used as such by any prospective purchaser. The services, systems and appliances shown have not been tested and no guarantee as to their operability or efficiency can be given.
Made with Metropix ©2024

