



## 33 Great Eastern Court Lower Clarence Road, Norwich

£850 PCM Leasehold

**\*ZERO DEPOSIT GUARANTEE AVAILABLE\*** Introducing this homely one-bedroom apartment that combines style, comfort and convenience. Situated just minutes from the city centre, this apartment offers an ideal living experience for a single professional seeking a modern home within easy reach of the city's offerings and transport links. AVAILABLE JULY.



## Location

This apartment is ideally located in the vibrant heart of Norwich, offering a dynamic blend of city convenience and riverside tranquillity. This contemporary residence is just a short walk from the bustling Norwich city centre, where an array of shops, restaurants, and cultural attractions await. For nature lovers, the beautiful Wensum River is right at your doorstep, providing scenic walking paths. Commuters will appreciate the proximity to Norwich Train Station, offering direct links to London and other major cities.



## Great Eastern Court

Upon entering the apartment, you are greeted by an open-plan kitchen/living room, ideal for modern living and entertaining. The space is flooded with ample natural light, creating a bright and airy feel. The well-designed layout maximises space and functionality, ensuring a comfortable living experience.

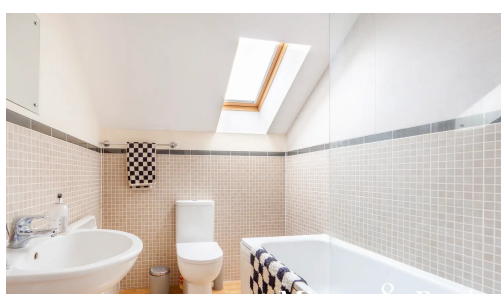



The generously proportioned bedroom provides a peaceful retreat at the end of the day. Its neutral decor and large windows enhance the sense of tranquillity and relaxation. The bathroom is also well-designed and finished to a high standard, offering a modern and chic aesthetic.

Situated in a prime location, this apartment is conveniently close to many amenities, including shops, cafes, restaurants, and public transportation options. Residents will appreciate the easy access to everyday necessities, making daily errands a breeze.

One of the key highlights of this property is its proximity to the city centre, with the bustling urban hub just a short walking distance away. Whether you prefer to explore the city's cultural attractions, dine at trendy eateries, or enjoy a stroll in the nearby parks, everything you need is within easy reach.



Minors & Brady

GROUND FLOOR

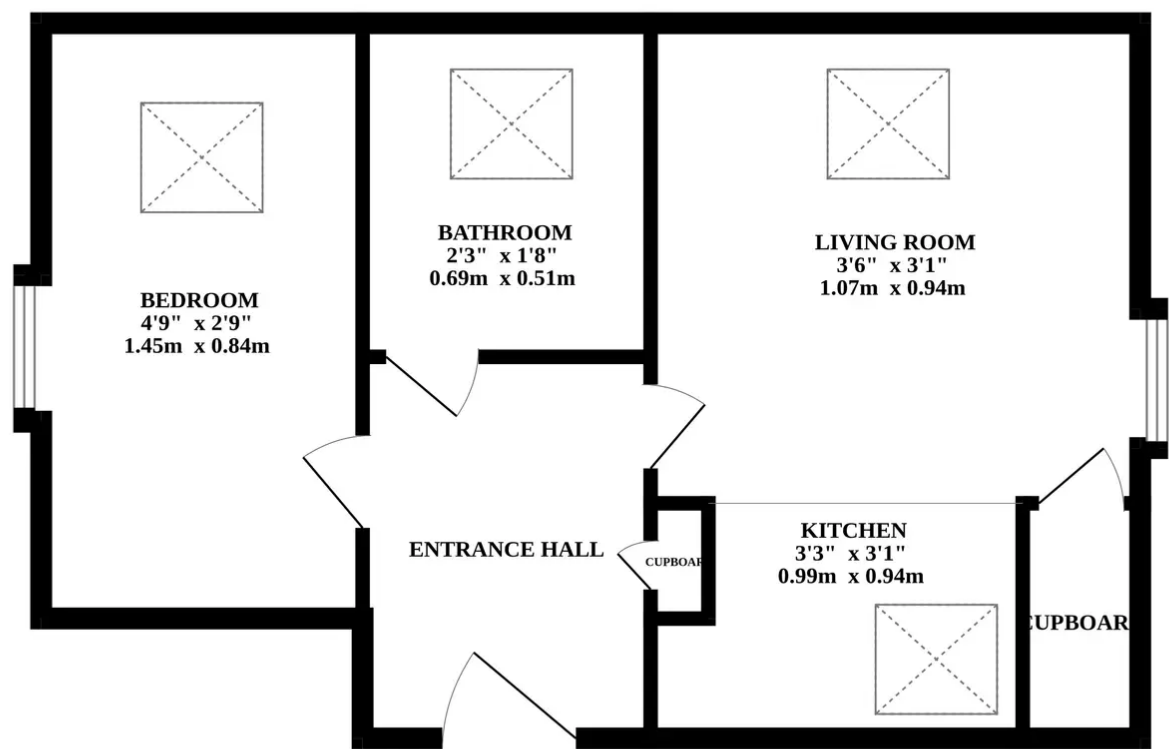

Whilst every attempt has been made to ensure the accuracy of the floorplan contained here, measurements of doors, windows, rooms and any other items are approximate and no responsibility is taken for any error, omission or mis-statement. This plan is for illustrative purposes only and should be used as such by any prospective purchaser. The services, systems and appliances shown have not been tested and no guarantee as to their operability or efficiency can be given.  
Made with Metropix ©2024

You can include any text here. The text can be modified upon generating your brochure.