



13 Prospect Place, Lowestoft

£250,000 Freehold

This charming three-bedroom terraced house, in the sought-after East Pakefield location, is situated on a quiet cul-de-sac, offering a serene and desirable living environment. Boasting a warm and inviting atmosphere, this property is the perfect fusion of modern comfort and classic elegance. This property offers a harmonious blend of comfort, convenience, and style, making it an ideal choice for those seeking a peaceful retreat in a desirable coastal setting.

Location

Prospect Place, Lowestoft, is perfectly situated in a vibrant coastal town known for its charming seafront and rich maritime heritage. This property is just a short walk from Lowestoft's stunning sandy beaches, offering residents the luxury of seaside living with picturesque sunrise views over the North Sea. The area is well-connected, with convenient access to local amenities, including shops, cafes, and restaurants, making daily life a breeze. Nearby parks and green spaces provide plenty of opportunities for outdoor activities, while excellent transport links, including the Lowestoft train station, connect you easily to Norwich and beyond. Whether you're seeking a peaceful coastal retreat or a lively community atmosphere, Prospect Place offers the best of both worlds.



Prospect Place

Upon entering the property, you are greeted by a spacious entrance hall that leads into a well-proportioned lounge featuring a multi-fuel stove/log burner crafted by Town & Country Fires, creating a cosy focal point perfect for relaxing evenings. The lounge seamlessly flows into a separate dining room, providing ample space for entertaining guests and family gatherings.



The fully-fitted kitchen boasts a range of quality units, extended work surfaces, and modern appliances, including a feature heated tea towel rail and a butler-style double ceramic sink with a single drainer. The kitchen also offers access to a rear lobby, granting entry to a tastefully designed bathroom with a panel bath, low-level W.C, pedestal sink, and a shower enclosed by a folding glass screen.

Upstairs, the property features three bedrooms, with the main bedroom offering generous storage space and the third bedroom presenting a versatile layout ideal for customisation to suit individual needs. Throughout the home, oak wood flooring exudes a sense of sophistication and warmth.

The exterior of the property features a well-maintained front garden adorned with an array of flowers and plants, leading to the welcoming front door. The rear garden provides a peaceful and private outdoor space, including a lawn area, a variety of flowers and shrubs, and a bespoke outbuilding fully insulated and double-glazed, offering endless possibilities as a tranquil retreat or functional workspace.



GROUND FLOOR

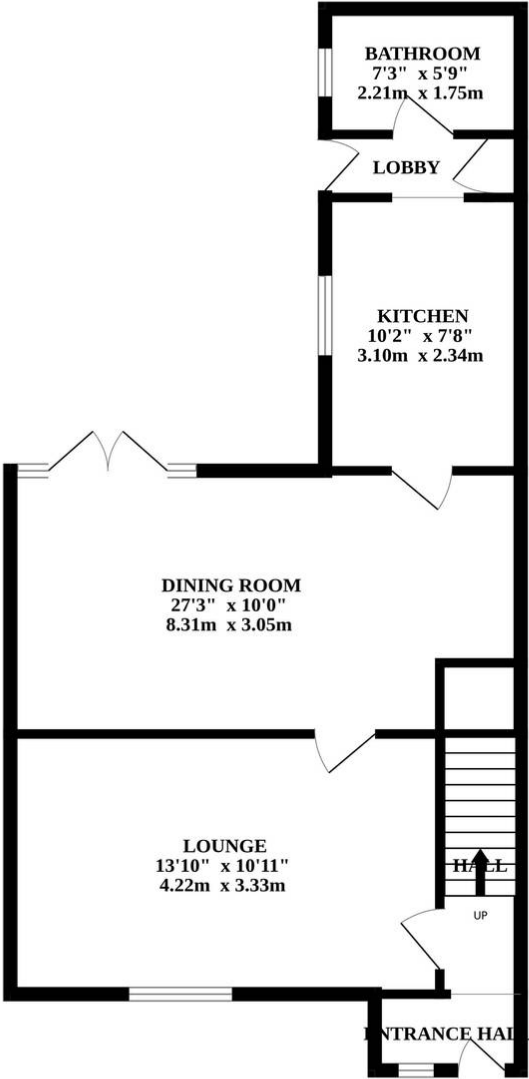

1ST FLOOR

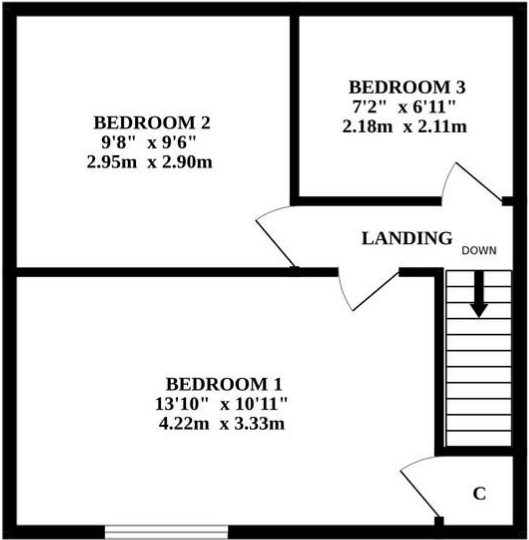

Whilst every attempt has been made to ensure the accuracy of the floorplan contained here, measurements of doors, windows, rooms and any other items are approximate and no responsibility is taken for any error, omission or mis-statement. This plan is for illustrative purposes only and should be used as such by any prospective purchaser. The services, systems and appliances shown have not been tested and no guarantee as to their operability or efficiency can be given.
Made with Metropix ©2024