



West Cottage South Walsham Road, Panxworth
£465,000

West Cottage South Walsham Road

Panxworth, Norwich

This ultimate countryside cottage is teeming with charm, light-filled features and breathtaking views offering a tranquil setting to enjoy the serene open-country lifestyle.

Council Tax band: C

Tenure: Freehold

EPC Energy Efficiency Rating: F

EPC Environmental Impact Rating: F





West Cottage South Walsham Road

Panxworth, Norwich

This ultimate countryside cottage is teeming with charm, light-filled features and breathtaking views. The stunning dining room serves as the sunlit heart of the home, with arched windows framing the rural landscape, while the exposed brick feature wall adds depth and texture. The galley-style kitchen radiates rustic appeal, blending with the cottage aesthetic. Spanning three floors, the property offers generous and flexible living spaces, including a luxurious main bedroom and a spa-like four-piece bathroom with roll-top bath and shower. Outside, the expansive garden, versatile summer house and tranquil seating area provide the perfect setting to enjoy the serene open-country lifestyle.

The Location

Panxworth is a picturesque semi-rural village situated approximately 7 miles from Norwich and 12 miles from the East Norfolk Coastline. This quiet location offers a countryside setting while still being conveniently close to the market town of Acle, which provides essential amenities such as schools, shops, and pubs just 3 miles away.

Additionally, residents can easily access the Norfolk Broads for leisure activities and explore various beaches along the coastline. With the proximity of Norwich International Airport and the nearby South Walsham village offering further amenities, Panxworth provides a desirable blend of rural charm and accessibility to nearby facilities and attractions.



West Cottage, South Walsham Road

Ground Floor
758 sq.ft. (70.4 sq.m.) approx.

1st Floor
265 sq.ft. (24.6 sq.m.) approx.

2nd Floor
298 sq.ft. (27.7 sq.m.) approx.

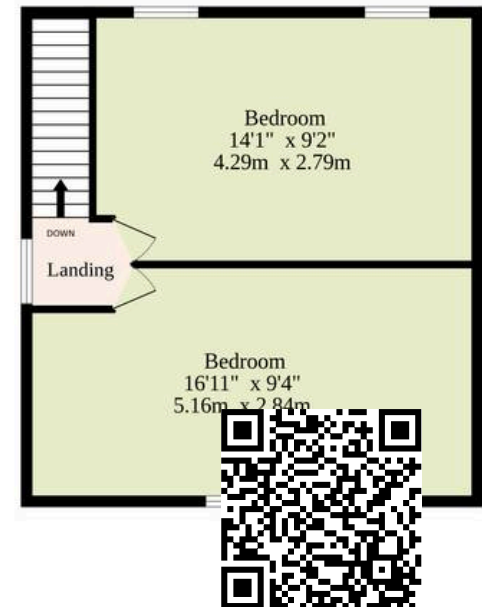
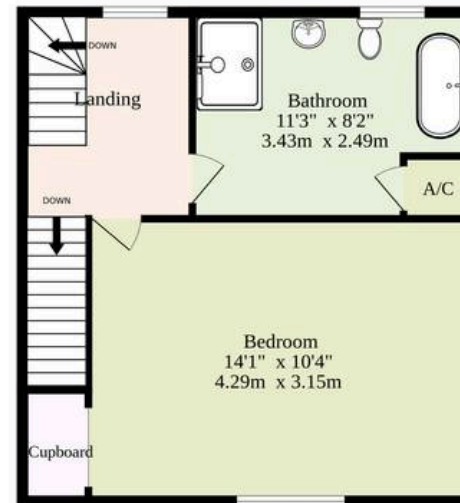

TOTAL FLOOR AREA : 1321 sq.ft. (122.7 sq.m.) approx.

Whilst every attempt has been made to ensure the accuracy of the floorplan contained here, measurements of doors, windows, rooms and any other items are approximate and no responsibility is taken for any error, omission or mis-statement. This plan is for illustrative purposes only and should be used as such by any prospective purchaser. The services, systems and appliances shown have not been tested and no guarantee as to their operability or efficiency can be given.

Made with Metropix ©2025