



Fen Farm Quidenham Road, Banham

In Excess of £400,000

Fen Farm Quidenham Road

Banham, Norwich

Situated on the edge of the charming village of Banham, Fen Farm is the epitome of chocolate box charm, offering a perfect blend of classic elegance and modern comfort. This delightful property is filled with natural light, featuring spacious interiors and a wealth of character, all set within beautifully landscaped gardens that complement the cottage style of the home, providing an idyllic setting for both relaxation and entertaining.

Location

Banham is a picturesque Norfolk village known for its rural charm, strong sense of community, and beautiful countryside surroundings. The village is home to the renowned Banham Zoo, a popular attraction for families and wildlife enthusiasts. Local amenities include a well-regarded primary school, a traditional pub, a village store, and a cosy café, ensuring a convenient and welcoming lifestyle. For those who enjoy the outdoors, there are plenty of scenic walking and cycling routes to explore, while the nearby market towns of Attleborough and Diss provide a wider range of shops, restaurants, and transport links, including direct rail services to Norwich and London. With its peaceful atmosphere and excellent local amenities, Banham offers the perfect balance of rural tranquillity and modern convenience.





Fen Farm Quidenham Road

Banham, Norwich

Upon entry, you are welcomed into a characterful hallway that leads to a spacious kitchen/breakfast area, where bespoke cream shaker-style units, a cosy fireplace, and a delightful view of the garden create a warm and inviting atmosphere. The adjoining utility room and a conveniently located shower room add to the practicality of this home. The living/dining area is a true highlight, with a stunning inglenook fireplace and large patio doors that open onto the garden, making it a perfect space for both family gatherings and entertaining. Full of rustic charm, this room is bathed in natural light and offers a wonderful connection to the outdoor spaces.

Upstairs, the home features two generous double bedrooms, each brimming with character, along with a charming single bedroom. A family bathroom, complete with a bath and shower attachment, serves the upstairs rooms.

Outside, the gardens have been thoughtfully designed to remain in keeping with the character of the property. The front garden is a picture-perfect scene, enclosed by lush hedging and offering stunning views of the surrounding fields. To the rear, a large paved patio provides an ideal spot for al fresco dining, while a beautifully maintained lawn, bordered by an array of plants and shrubs, enhances the cottage feel of the home. The property also benefits from ample off-road parking and a spacious driveway enclosed by a traditional five-bar gate.



With its timeless appeal and storybook charm, Fen Farm is a truly special home. A viewing is highly recommended to appreciate everything this delightful

Ground Floor
477 sq.ft. (44.3 sq.m.) approx.

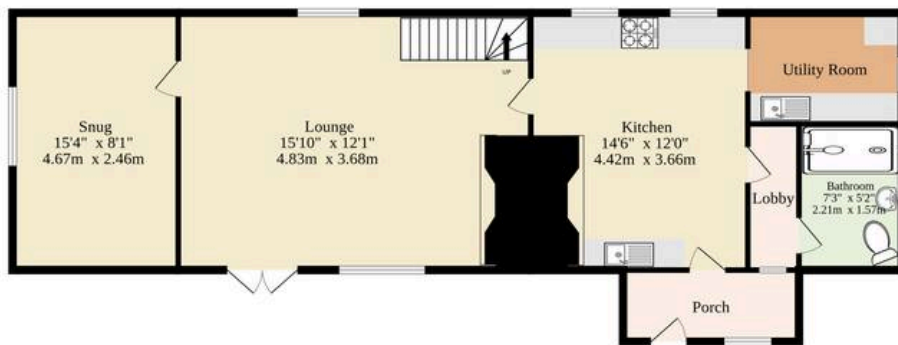

1st Floor
630 sq.ft. (58.5 sq.m.) approx.

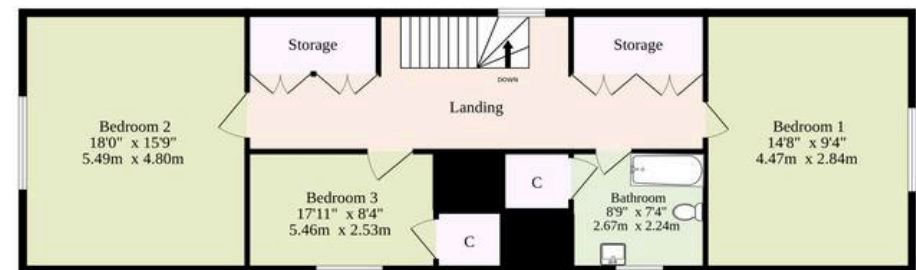

TOTAL FLOOR AREA : 1107 sq.ft. (102.8 sq.m.) approx.

Whilst every attempt has been made to ensure the accuracy of the floorplan contained here, measurements of doors, windows, rooms and any other items are approximate and no responsibility is taken for any error, omission or mis-statement. This plan is for illustrative purposes only and should be used as such by any prospective purchaser. The services, systems and appliances shown have not been tested and no guarantee as to their operability or efficiency can be given.
Made with Metropix ©2025

