



7 Daniels Road, Norwich

In Excess of £975,000

7 Daniels Road

Norwich, Norwich

Secure an exquisitely extended and masterfully renovated 1950s detached home, offering in excess of 2,000sqft of refined living space. The comprehensive renovation is complete with a full re-wire, a Hive heating system, a brand new boiler, fully plastered, a Patmore water softener system that serves the whole residence, and underfloor heating in the extension. The extension has gained an additional 60sqm of living space, transforming this family home into an entertainer's dream, with a showstopper kitchen and family room, showcasing premium fixtures and finishing's, including high-spec appliances, rolled edge quartz worktops, a grand central island, a stylish media wall, two roof lanterns and large bi-fold doors that opens out to the porcelain terrace. Further enhancing the property's allure are three inviting reception rooms, an annex-style bedroom suite, three first-floor double bedrooms, and luxury bathroom suites. Set on a substantial, secluded plot, the home benefits from an expansive garden offering endless possibilities, a brick-weave driveway providing ample off-road parking, and an integral garage for storage options. Acquire this one-of-a-kind home that redefines modern living to new standards.

Council Tax band: E

Tenure: Freehold

EPC Energy Efficiency Rating: D

EPC Environmental Impact Rating:





7 Daniels Road

Norwich, Norwich

Secure an exquisitely extended and masterfully renovated 1950s detached home, offering in excess of 2,000sqft of refined living space. The comprehensive renovation is complete with a full re-wire, a Hive heating system, a brand new boiler, fully plastered, a Patmore water softener system that serves the whole residence, and underfloor heating in the extension. The extension has gained an additional 60sqm of living space, transforming this family home into an entertainer's dream, with a showstopper kitchen and family room, showcasing premium fixtures and finishing's, including high-spec appliances, rolled edge quartz worktops, a grand central island, a stylish media wall, two roof lanterns and large bi-fold doors that opens out to the porcelain terrace. Further enhancing the property's allure are three inviting reception rooms, an annex-style bedroom suite, three first-floor double bedrooms, and luxury bathroom suites. Set on a substantial, secluded plot, the home benefits from an expansive garden offering endless possibilities, a brick-weave driveway providing ample off-road parking, and an integral garage for storage options. Acquire this one-of-a-kind home that redefines modern living to new standards.

Explore the location...

Daniels Road is situated in the sought-after NR4 area of Norwich, offering convenient access to both the city centre and the outskirts of Norwich. This well-connected road lies just south-west of the city, providing excellent transport links via the A11 and the A140, with multiple bus routes and Norwich



Ground Floor
1416 sq.ft. (131.6 sq.m.) approx.



1st Floor
629 sq.ft. (58.4 sq.m.) approx.

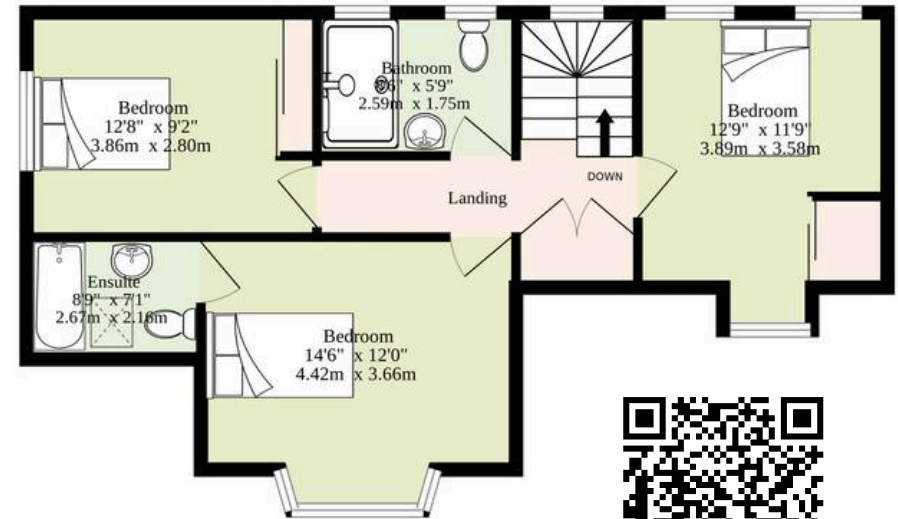

TOTAL FLOOR AREA : 2045 sq.ft. (190.0 sq.m.) approx.

Whilst every attempt has been made to ensure the accuracy of the floorplan contained here, measurements of doors, windows, rooms and any other items are approximate and no responsibility is taken for any error, omission or mis-statement. This plan is for illustrative purposes only and should be used as such by any prospective purchaser. The services, systems and appliances shown have not been tested and no guarantee as to their operability or efficiency can be given.

Made with Metropix ©2025

