



Halt The Street, Barton Turf

In Excess of £350,000

Halt The Street

Barton Turf, Norwich

This contemporary home prioritises light and open living. Stepping inside, you're welcomed by a spacious living/kitchen area ideal for entertaining or relaxing. The stylish kitchen boasts integrated appliances, wooden countertops and a ranger cooker. Flooded with natural light from French doors and windows, the home feels airy and bright. A modern bathroom with mosaic-style flooring complements the large double bedroom, designed for tranquility with soothing blue tones and views of the wrap-around courtyard garden. Picturesque views of Barton Broad add a touch of beauty to this charming property.

THE LOCATION

The Street in Barton Turf encapsulates the essence of idyllic countryside living. Nestled within the heart of Norfolk's picturesque landscape, this charming village road exudes tranquillity and a timeless sense of community. Barton Turf, itself, is renowned for its unspoiled natural beauty, with meandering waterways, lush green fields, and a network of footpaths that beckon outdoor enthusiasts. The Street embodies the quintessential English village atmosphere, where historic cottages and houses seamlessly blend with the surrounding pastoral scenery. Residents here enjoy a peaceful retreat from the hustle and bustle of city life, while still benefiting from convenient access to nearby amenities and the stunning Norfolk Broads.





Halt The Street

Barton Turf, Norwich

THE STREET

Stepping into the property, you are greeted by the inviting open-concept living/kitchen area, perfect for entertaining guests or enjoying a quiet evening in. The tastefully designed kitchen is equipped with integrated appliances, wooden countertops and a ranger cooker, creating a space that is both functional and stylish. The property boasts an abundance of natural light that floods in through French doors and numerous windows, enhancing the airy and open feel of the home.

The three-piece bathroom features contemporary sanitary ware, chrome accents and mosaic-style flooring, adding a touch of elegance to the space. The large double bedroom, designed with a soothing blue theme, offers a retreat for relaxation and rest. The bedroom provides ample space and comfort, with views of the wrap-around courtyard-style gardens that surround the property.





Halt The Street

Barton Turf, Norwich

The exterior features charming brick accents, mature hedging, and a driveway, adding to the overall appeal of the home. One of the highlights of this property is the picturesque views that stretch along the Barton Broad, offering a scenic backdrop that can be enjoyed from the comfort of your own home.

AGENTS NOTE

We understand this property will be sold freehold, connected to mains electricity, water and water treatment plant (2022)

Council Tax Band - B



GROUND FLOOR

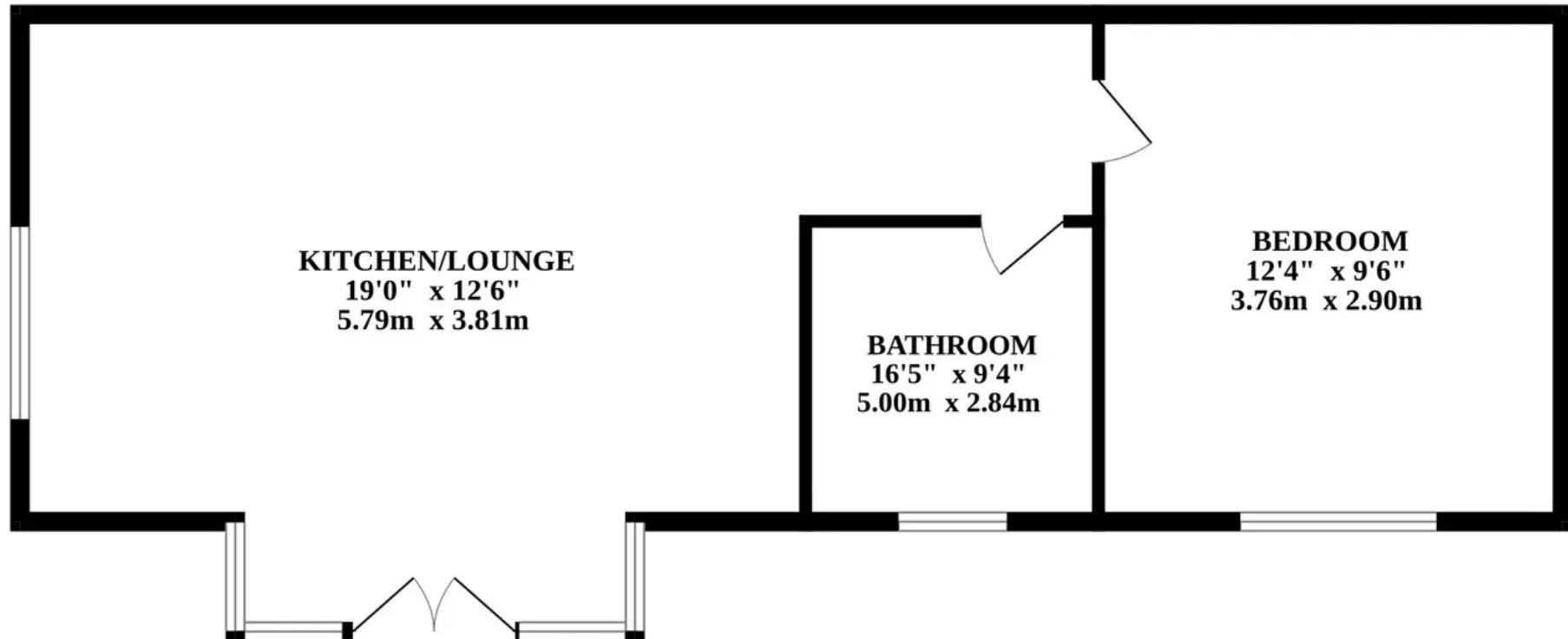

Whilst every attempt has been made to ensure the accuracy of the floorplan contained here, measurements of doors, windows, rooms and any other items are approximate and no responsibility is taken for any error, omission or mis-statement. This plan is for illustrative purposes only and should be used as such by any prospective purchaser. The services, systems and appliances shown have not been tested and no guarantee as to their operability or efficiency can be given.
Made with Metropix ©2024