

## 417 The Glebe, Hemsby

£220,000 Leasehold

**GUIDE PRICE: £220,000-£230,000.** Uninterrupted sea views stretch endlessly from this stunning detached home in The Glebe, Hemsby, capturing the true coastal lifestyle. Set on a generous quarter-acre plot, (stms) it features expansive decking and cedar wood gazebos, perfect for outdoor relaxation and entertaining. Inside, a fully renovated open-plan living space includes a brand new white kitchen and bi-fold doors that flow effortlessly to the outdoors. Two spacious double bedrooms with high-end scratch-proof flooring provide durability for a beachside home. Thoughtfully insulated for year-round comfort, the property also boasts a large modern double shower room. With parking for up to eight cars and a cohesive coastal theme, this home is ideal as a stylish permanent home or holiday let.

Council Tax band: A

Tenure: Leasehold

GUIDE PRICE: £220,000-£230,000. Uninterrupted sea views stretch endlessly from this stunning detached home in The Glebe, Hemsby, capturing the true coastal lifestyle. Set on a generous quarter-acre plot, (stms) it features expansive decking and cedar wood gazebos, perfect for outdoor relaxation and entertaining. Inside, a fully renovated open-plan living space includes a brand new white kitchen and bi-fold doors that flow effortlessly to the outdoors. Two spacious double bedrooms with high-end scratch-proof flooring provide durability for a beachside home. Thoughtfully insulated for year-round comfort, the property also boasts a large modern double shower room. With parking for up to eight cars and a cohesive coastal theme, this home is ideal as a stylish permanent home or holiday let.

### The Location

The Glebe in Hemsby is a popular coastal location known for its proximity to sandy beaches and scenic seaside attractions. In the heart of Hemsby, this area offers easy access to local amenities, including a range of shops, cafés, and restaurants, ideal for both residents and holiday visitors.



GUIDE PRICE: £220,000-£230,000. Uninterrupted sea views stretch endlessly from this stunning detached home in The Glebe, Hemsby, capturing the true coastal lifestyle. Set on a generous quarter-acre plot, (stms) it features expansive decking and cedar wood gazebos, perfect for outdoor relaxation and entertaining. Inside, a fully renovated open-plan living space includes a brand new white kitchen and bi-fold doors that flow effortlessly to the outdoors. Two spacious double bedrooms with high-end scratch-proof flooring provide durability for a beachside home. Thoughtfully insulated for year-round comfort, the



**GUIDE PRICE: £220,000-£230,000.** Uninterrupted sea views stretch endlessly from this stunning detached home in The Glebe, Hemsby, capturing the true coastal lifestyle. Set on a generous quarter-acre plot, (stms) it features expansive decking and cedar wood gazebos, perfect for outdoor relaxation and entertaining. Inside, a fully renovated open-plan living space includes a brand new white kitchen and bi-fold doors that flow effortlessly to the outdoors. Two spacious double bedrooms with high-end scratch-proof flooring provide durability for a beachside home. Thoughtfully insulated for year-round comfort, the property also boasts a large modern double shower room. With parking for up to eight cars and a cohesive coastal theme, this home is ideal as a stylish permanent home or holiday let.

### The Location

The Glebe in Hemsby is a popular coastal location known for its proximity to sandy beaches and scenic seaside attractions. In the heart of Hemsby, this area offers easy access to local amenities, including a range of shops, cafés, and restaurants, ideal for both residents and holiday visitors.

The nearby beach is a favourite for families and tourists, featuring arcades, amusements, and traditional seaside entertainment. Hemsby is also well-connected to surrounding areas, with Great Yarmouth just a short drive away, offering further shopping, dining, and leisure options.#

### The Glebe, Hemsby

Just moments from the sparkling sea, this detached home offers breathtaking uninterrupted sea views that stretch as far as the eye can see. Set on a generous plot of approximately a quarter of an acre, the garden feels like an extension of the beach itself, creating an incredible outdoor living experience.

Expansive decking areas provide ample space for both lounging and alfresco dining, while the elegant cedar wood gazebos topped with durable aluminum roofs add a touch of coastal charm and shelter for those relaxed summer afternoons.

Inside, the home has been fully renovated to an impeccable standard, showcasing a fresh and modern interior designed with comfort and style in mind. The brand new white kitchen seamlessly flows into an open-plan living area, enhanced by bi-fold doors that flood the space with natural light and offer effortless access to the outdoor decks.

The coastal theme runs thoughtfully throughout, creating a fresh, airy atmosphere that perfectly complements the stunning sea views and surrounding nature.



**Ground Floor**  
**603 sq.ft. (56.0 sq.m.) approx.**

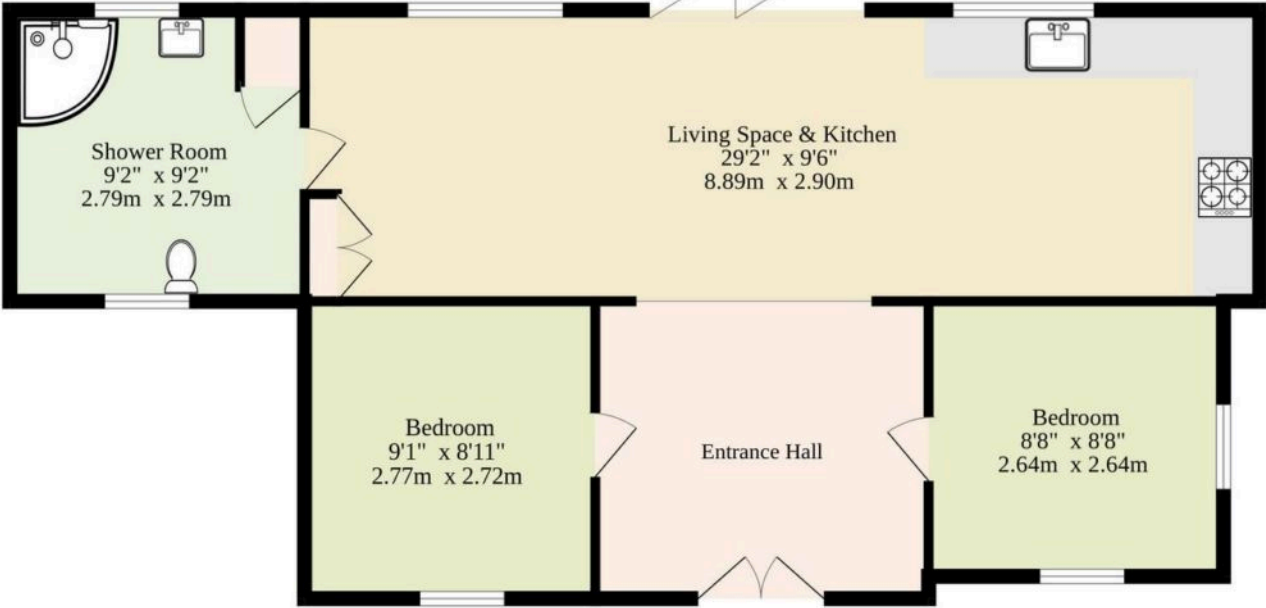

TOTAL FLOOR AREA : 603 sq.ft. (56.0 sq.m.) approx.  
Whilst every attempt has been made to ensure the accuracy of the floorplan contained here, measurements of doors, windows, rooms and any other items are approximate and no responsibility is taken for any error, omission or mis-statement. This plan is for illustrative purposes only and should be used as such by any prospective purchaser. The services, systems and appliances shown have not been tested and no guarantee as to their operability or efficiency can be given.  
Made with Metropix ©2025

You can include any text here. The text can be modified upon generating your brochure.

You can include any text here. The text can be modified upon generating your brochure.

