



2d Spencer Street, Norwich

£110,000 Leasehold

This ground-floor apartment in the heart of a sought-after area presents a great opportunity for investors or first-time buyers looking for a well-located residence. Situated in a convenient location within walking distance of the town centre and close to various amenities, this one-bedroom property offers a comfortable and practical living space. The apartment is currently being rented at £725 per month.

This ground-floor apartment in the heart of a sought-after area presents a great opportunity for investors or first-time buyers looking for a well-located residence. Situated in a convenient location within walking distance of the town centre and close to various amenities, this one-bedroom property offers a comfortable and practical living space. The apartment is currently being rented at £725 per month.

Location

Located at Spencer Street, Norwich, this property offers a blend of city convenience and suburban tranquillity. It is within walking distance of local amenities, including shops, cafes, and parks. The property benefits from transport links, with Norwich city centre and its cultural attractions, dining options, and shopping centres just a short drive or bus ride away. For families, there are well-regarded schools in the vicinity, making it an ideal location for all stages of life. The surrounding neighbourhood is known for its community spirit and green spaces, providing a friendly environment. This address



This ground-floor apartment in the heart of a sought-after area presents a great opportunity for investors or first-time buyers looking for a well-located residence. Situated in a convenient location within walking distance of the town centre and close to various amenities, this one-bedroom property offers a comfortable and practical living space. The apartment is currently being rented at £725 per month.

Location

Located at Spencer Street, Norwich, this property offers a blend of city convenience and suburban



This ground-floor apartment in the heart of a sought-after area presents a great opportunity for investors or first-time buyers looking for a well-located residence. Situated in a convenient location within walking distance of the town centre and close to various amenities, this one-bedroom property offers a comfortable and practical living space. The apartment is currently being rented at £725 per month.

Location

Located at Spencer Street, Norwich, this property offers a blend of city convenience and suburban tranquillity. It is within walking distance of local amenities, including shops, cafes, and parks. The property benefits from transport links, with Norwich city centre and its cultural attractions, dining options, and shopping centres just a short drive or bus ride away. For families, there are well-regarded schools in the vicinity, making it an ideal location for all stages of life. The surrounding neighbourhood is known for its community spirit and green spaces, providing a friendly environment. This address combines the best of both worlds, offering a comfortable and convenient lifestyle in one of Norwich's most desirable areas.

Spencer Street, Norwich

Upon entering the property, you are welcomed into a spacious hallway that leads you to the lounge. The reception room is inviting and bright, offering a flexible space for relaxation or entertaining guests. Continuing through the apartment, you will find the well-appointed kitchen, providing a functional area for culinary endeavours.

The bedroom is generously sized and offers ample living space for its residents. The thoughtful layout of the property ensures a harmonious flow between the living spaces, promoting ease of living and functionality. The accommodation is completed by a modern shower room, adding to the convenience and comfort of the apartment.

A bonus of this property is the communal roof terrace, offering an outdoor space for residents to enjoy. Whether you are looking to unwind or admire city views, this communal area is sure to impress. The convenience of on-road parking ensures that you will always have a place for your vehicle, adding to the overall practicality of the apartment.

Located in a desirable area of Norwich, residents can enjoy easy access to a range of amenities, including shops, restaurants, pubs and transport links.



GROUND FLOOR

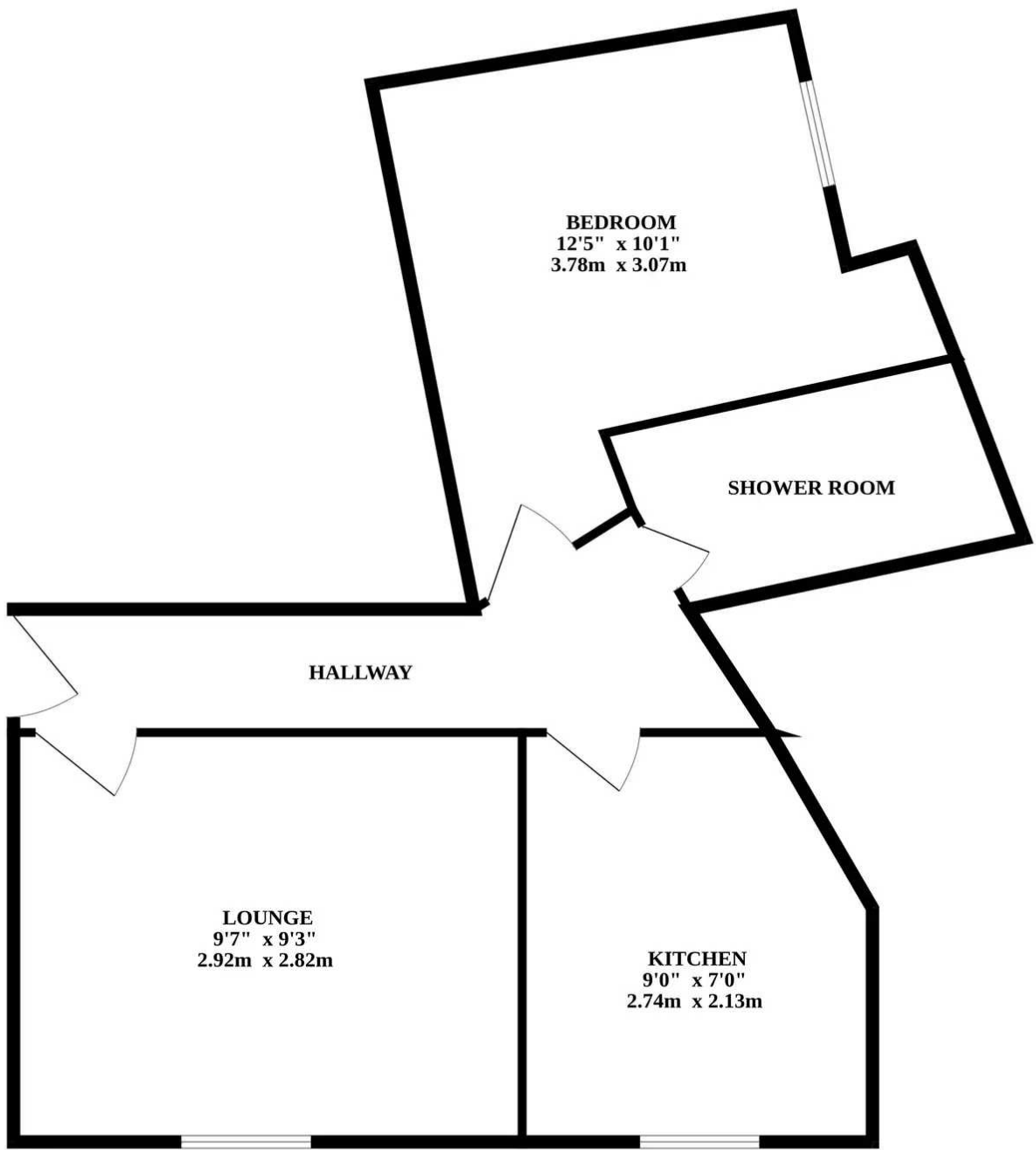

Whilst every attempt has been made to ensure the accuracy of the floorplan contained here, measurements of doors, windows, rooms and any other items are approximate and no responsibility is taken for any error, omission or mis-statement. This plan is for illustrative purposes only and should be used as such by any prospective purchaser. The services, systems and appliances shown have not been tested and no guarantee as to their operability or efficiency can be given.
Made with Metropix ©2024

You can include any text here. The text can be modified upon generating your brochure.

You can include any text here. The text can be modified upon generating your brochure.

