



42 Apollo Crescent, Norwich

£230,000 Freehold

Guide Price £230,000 - £240,000. Step into stylish modern living with this two-bedroom end terrace home in Costessey, perfectly positioned for easy access to Norwich and the surrounding countryside. Ideal for first-time buyers, the open-plan lounge and kitchen offer a bright, inviting space that opens onto a private garden, perfect for relaxing or entertaining. Upstairs, two spacious bedrooms include a master with a handy en-suite bathroom, adding a touch of comfort. The enclosed garden and driveway with parking for two cars provide excellent outdoor space and practicality. Close to schools, parks, and excellent transport links, this home suits a busy lifestyle with ease. Ready to move into, it's a great opportunity to enjoy a modern home in a welcoming community.

Guide Price £230,000 - £240,000. Step into stylish modern living with this two-bedroom end terrace home in Costessey, perfectly positioned for easy access to Norwich and the surrounding countryside. Ideal for first-time buyers, the open-plan lounge and kitchen offer a bright, inviting space that opens onto a private garden, perfect for relaxing or entertaining. Upstairs, two spacious bedrooms include a master with a handy en-suite bathroom, adding a touch of comfort. The enclosed garden and driveway with parking for two cars provide excellent outdoor space and practicality. Close to schools, parks, and excellent transport links, this home suits a busy lifestyle with ease. Ready to move into, it's a great opportunity to enjoy a modern home in a welcoming community.

The Location

Located in the area of Costessey, Apollo Crescent, Norwich, offers the perfect balance between city living and access to the surrounding countryside. A short drive from Norwich city centre, residents are positioned to enjoy excellent local amenities, including schools, parks, and shopping facilities,



Guide Price £230,000 - £240,000. Step into stylish modern living with this two-bedroom end terrace home in Costessey, perfectly positioned for easy access to Norwich and the surrounding countryside. Ideal for first-time buyers, the open-plan lounge and kitchen offer a bright, inviting space that opens onto a private garden, perfect for relaxing or entertaining. Upstairs, two spacious bedrooms include a master with a handy en-suite bathroom, adding a touch of comfort. The enclosed garden and driveway with parking for two cars provide excellent outdoor space and



Guide Price £230,000 - £240,000. Step into stylish modern living with this two-bedroom end terrace home in Costessey, perfectly positioned for easy access to Norwich and the surrounding countryside. Ideal for first-time buyers, the open-plan lounge and kitchen offer a bright, inviting space that opens onto a private garden, perfect for relaxing or entertaining. Upstairs, two spacious bedrooms include a master with a handy en-suite bathroom, adding a touch of comfort. The enclosed garden and driveway with parking for two cars provide excellent outdoor space and practicality. Close to schools, parks, and excellent transport links, this home suits a busy lifestyle with ease. Ready to move into, it's a great opportunity to enjoy a modern home in a welcoming community.

The Location

Located in the area of Costessey, Apollo Crescent, Norwich, offers the perfect balance between city living and access to the surrounding countryside. A short drive from Norwich city centre, residents are positioned to enjoy excellent local amenities, including schools, parks, and shopping facilities, making it ideal for families and professionals alike.

Families will particularly benefit from the nearby parks and green spaces, perfect for outdoor activities and relaxed strolls. The property is also within close proximity to key road networks, ensuring an easy commute to Norwich city and beyond. Public transport options are readily available, with local bus routes offering direct access to key destinations such as the Norfolk and Norwich University Hospital, the University of East Anglia (UEA) and the city centre. This makes it incredibly convenient for students, healthcare professionals, and those working in the city to get where they need to be without hassle.

Apollo Crescent, Costessey

This modern two-bedroom end terrace house offers a fantastic opportunity, especially for first-time buyers seeking a stylish and practical home in a popular location. Set on the well-regarded Hampden View estate in New Costessey, the property combines contemporary living with convenient features designed to suit everyday needs.

Step inside to a welcoming entrance hall that leads seamlessly to all rooms and includes useful storage space. The heart of the home is the open-plan lounge and kitchen, where natural light floods through French doors opening onto the rear garden.

The kitchen is thoughtfully fitted with a range of units and modern appliances, creating an ideal space for cooking and



Ground Floor
320 sq.ft. (29.7 sq.m.) approx.

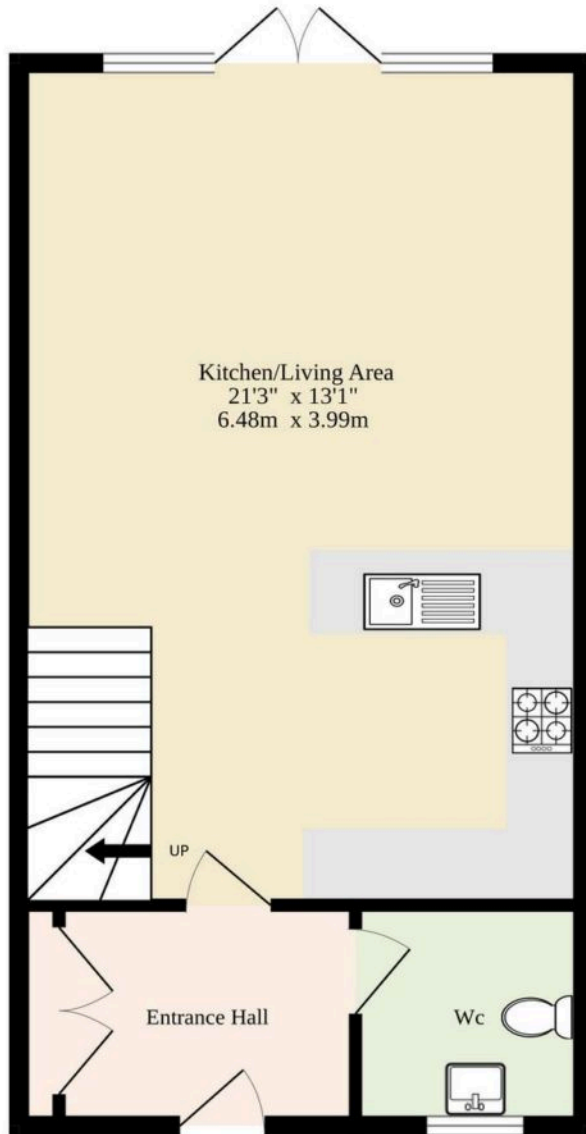

1st Floor
323 sq.ft. (30.0 sq.m.) approx.

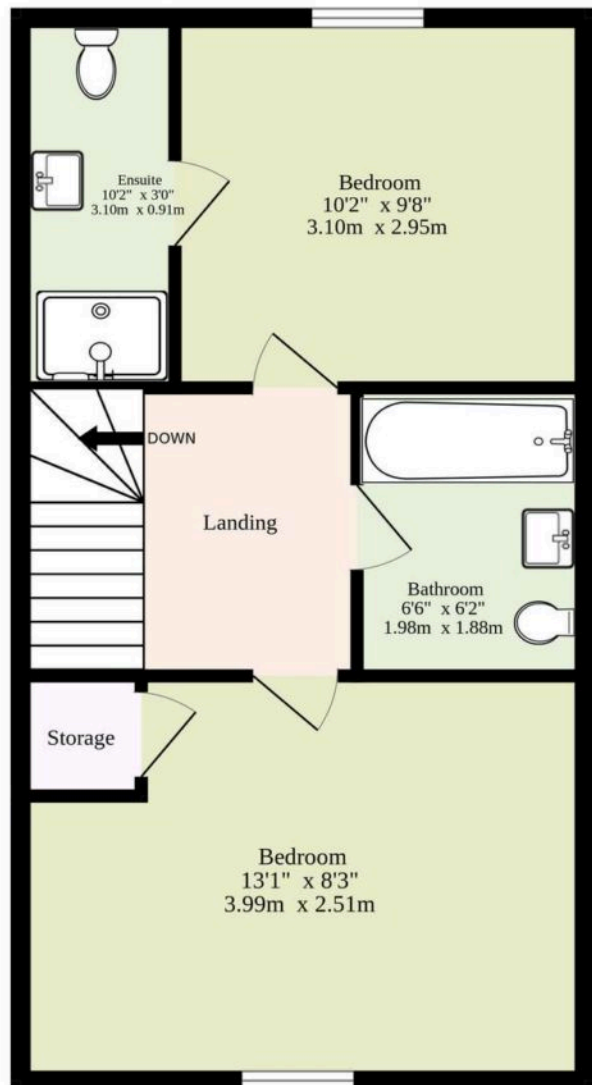

TOTAL FLOOR AREA : 643 sq.ft. (59.7 sq.m.) approx.

Whilst every attempt has been made to ensure the accuracy of the floorplan contained here, measurements of doors, windows, rooms and any other items are approximate and no responsibility is taken for any error, omission or mis-statement. This plan is for illustrative purposes only and should be used as such by any prospective purchaser. The services, systems and appliances shown have not been tested and no guarantee as to their operability or efficiency can be given.

Made with Metropix ©2025

You can include any text here. The text can be modified upon generating your brochure.

You can include any text here. The text can be modified upon generating your brochure.

