



231 The Marrams, Hemsby

Great Yarmouth



Minors & Brady



## 231 The Marrams

Hemsby, Great Yarmouth

Elevated in position and offering distant sea views, this charming two-bedroom chalet in The Marrams, Hemsby, is a true coastal gem. Beautifully presented throughout, it features a cheerful pink entrance hall, a wraparound sitting area, and a well-equipped, classic kitchen perfect for holiday stays. The interiors reflect a subtle coastal theme, creating a relaxed, beachy atmosphere ideal for unwinding. A sleek, modern shower room complements the two comfortable bedrooms, ensuring convenience and style. Outside, the private, south-facing garden with its raised decking provides a sunny retreat with glimpses of the sea. Just moments from the sandy beach and Hemsby's seaside attractions, the location is both peaceful and vibrant. Whether for holiday letting, personal getaways, or a second home by the sea, this delightful chalet offers the perfect blend of comfort, charm, and coastal living.

- Detached two-bedroom non-standard bungalow
- Ideal home for first time buyers, couples or those looking to downsize
- Everything on a single floor providing ease of accessibility
- Elevated position on a generous plot with off-street parking
- Fitted kitchen with access to rear garden
- Lounge extending over 17ft in length
- South-facing rear garden and additional front garden
- Two spacious bedrooms with the main bedroom benefitting from built in wardrobes
- Coastal location just moments from Hemsby beach







M&B



## 231 The Marrams

Hemsby, Great Yarmouth

### The Location

Located in the popular coastal village of Hemsby, The Marrams offers a distinctive blend of natural scenery and everyday convenience. This charming area is best known for its wide, sandy beaches and dramatic dune landscapes, creating a beautiful and calming environment ideal for beachcombing, walking, or simply enjoying the fresh sea air. The coastline stretches for miles, providing ample space for outdoor recreation and relaxation in all seasons.

Just a short walk from the property, Hemsby Beach is alive with classic seaside attractions. Visitors and residents alike can enjoy family-friendly arcades, amusement rides and mini-golf, as well as a variety of local dining options. From traditional fish and chips to cosy cafés and ice cream stands, there's something to suit every taste.

While Hemsby attracts many holidaymakers, it maintains a peaceful and friendly atmosphere, making it equally appealing for year-round living. Essential amenities are close at hand, and the area serves as a great base for exploring more of the Norfolk coast and countryside.



M&B



## 231 The Marrams

Hemsby, Great Yarmouth

### The Marrams

Tucked away in the sought-after Marrams area of Hemsby, this charming chalet offers a coastal retreat perfect for holiday escapes or as a delightful holiday home. As you step inside, you're greeted by a subtle pink entrance hall and dining space that sets a cheerful tone from the outset.

The interior opens into a cosy sitting area that gently wraps around, creating an inviting space to relax and unwind after a day by the sea.

The modern kitchen, while classic in style, is well-equipped and tailored for convenience, ideal for laid-back holiday living. Throughout the chalet, a subtle coastal theme flows seamlessly, offering a relaxed, beachy atmosphere that reflects the property's idyllic location.

There are two comfortable bedrooms, thoughtfully presented to ensure a peaceful night's sleep, along with a sleek, modern shower room that adds a touch of contemporary style. Step outside and you'll find a private garden space, elevated with a decked area that captures glimpses of the sea splashing in the distance.

The south-facing rear garden enjoys plenty of sunshine and provides a tranquil spot for morning coffee or evening drinks. With the golden sands of Hemsby beach just steps away, this chalet is a rare opportunity to embrace seaside living in one of Norfolk's most cherished coastal communities.



**Ground Floor**  
**453 sq.ft. (42.1 sq.m.) approx.**

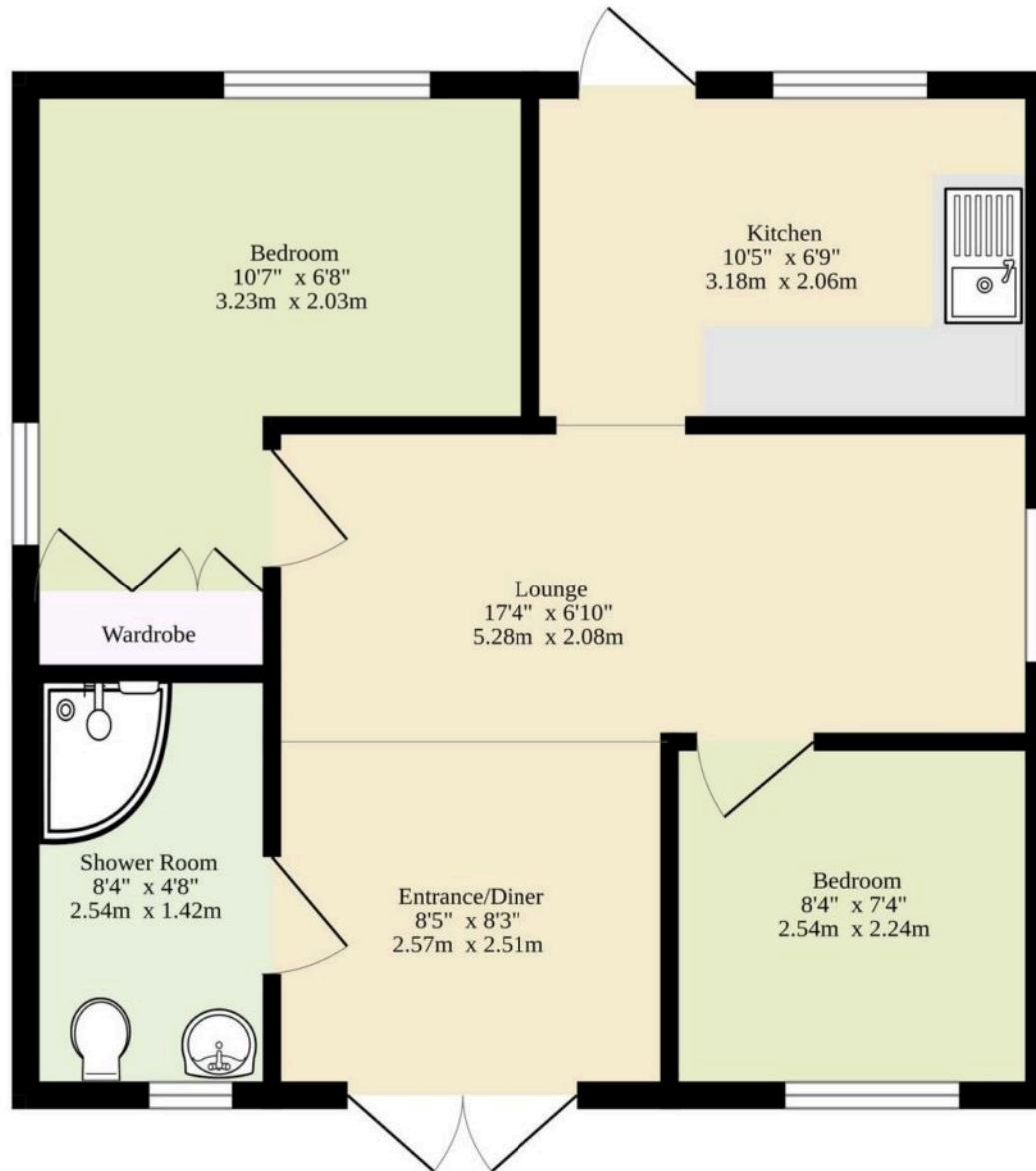

TOTAL FLOOR AREA : 453 sq.ft. (42.1 sq.m.) approx.

Whilst every attempt has been made to ensure the accuracy of the floorplan contained here, measurements of doors, windows, rooms and any other items are approximate and no responsibility is taken for any error, omission or mis-statement. This plan is for illustrative purposes only and should not be used as such by any prospective purchaser. The services, systems and appliances shown have not been tested and no guarantee as to their operability or efficiency can be given.  
Made with Metropix ©2025



# Dreaming of this home? Let's make it a reality



*Meet Sarah*  
Senior Property Consultant



*Meet James*  
Property Consultant



*Meet Lauren*  
Property Consultant

**Minors & Brady**  
*Your home, our market*

 [caister@minorsandbrady.co.uk](mailto:caister@minorsandbrady.co.uk)

 01493 806188

 48 High Street, Caister-on-Sea, Great Yarmouth, NR30 5EH

CAISTER-ON-SEA | DEREHAM | DISS | NORWICH | OULTON BROAD | WROXHAM



## How can we support

- ✓ Residential Mortgages
- ✓ Protection & Insurance
- ✓ Buy-to-let (personal and limited company)



**Matt Waters**  
Senior Mortgage  
and Protection Advisor



**Victoria Payne**  
Mortgage and  
Protection Advisor

**Book your free financial  
review today.**

**T: 01692 531372  
E: [enquiries@norfolk-mortgages.co.uk](mailto:enquiries@norfolk-mortgages.co.uk)**