



4 Kerrison Close, Ormesby

Great Yarmouth



Minors & Brady

4 Kerrison Close

Ormesby, Great Yarmouth

This three-bedroom home in Kerrison Close, Ormesby, is available on a 40% shared ownership basis and offers an ideal first step onto the property ladder. The property features a welcoming entrance hall, downstairs WC, bright sitting room, and a modern kitchen diner with patio doors leading to a large garden. Upstairs are three well-proportioned bedrooms, including a spacious main with dual windows, plus a family bathroom. Externally, the home benefits from a generous garden and two allocated parking spaces. Located in a peaceful village close to the Norfolk coast and everyday amenities, it combines convenience with a community setting. Chain free and expected to attract strong interest – be quick to arrange a viewing!

- 40% shared ownership opportunity – ideal for first-time buyers
- Chain free – a smoother and straightforward purchase
- Situated in a peaceful residential cul-de-sac in Ormesby
- Welcoming entrance hall with downstairs WC
- Bright sitting room with front-facing window
- Modern kitchen diner with patio doors to the garden
- Three bedrooms including a spacious main with dual windows
- Family bathroom with a modern three-piece suite
- Large rear garden, perfect for families or entertaining
- Two allocated parking spaces for convenience

M&B





M&B

4 Kerrison Close

Ormesby, Great Yarmouth

The Location

Kerrison Close enjoys a peaceful residential setting in the well-served village of Ormesby, just a short drive from the Norfolk coast.

Surrounded by open countryside and a strong sense of community, Ormesby offers a range of everyday amenities, including a convenience store, pub, primary school, and local healthcare facilities.

The nearby beaches of California and Scratby provide easy access to scenic coastal walks and seaside attractions, while Great Yarmouth and Norwich are both within easy reach by car or public transport, offering broader shopping, dining, and leisure options.



4 Kerrison Close

Ormesby, Great Yarmouth

Kerrison Close, Ormesby

An excellent opportunity to get onto the property ladder with this well-presented three-bedroom home, available on a 40% shared ownership basis and located in the popular area of Ormesby.

On entering the property, you are welcomed by a bright entrance hall with access to a convenient ground floor WC. To the front of the home sits a comfortable sitting room with a large window, filling the space with natural light. To the rear, the modern kitchen diner offers a practical layout with ample storage and dining space, as well as patio doors that open directly onto the garden, perfect for entertaining and family living.

Upstairs, the property boasts three well-proportioned bedrooms. The main bedroom is particularly spacious and benefits from two windows to the front aspect, creating a light and airy feel. To the rear are two further bedrooms, both overlooking the garden. Completing the first floor is a family bathroom fitted with a modern three-piece suite.



4 Kerrison Close

Ormesby, Great Yarmouth

Externally, the property enjoys a generously sized garden, offering plenty of space for outdoor seating, play, or gardening. There are also two allocated parking spaces for added convenience.

This home is an ideal choice for first-time buyers looking to take their first step onto the property ladder. With spacious accommodation, a large garden, and a desirable location in Ormesby, this shared ownership property is not to be missed.

Agents Note

Sold Leasehold (years remaining - TBC)

Maintenance & Ground Rent combined: £400

40% Shared Ownership eligibility criteria apply, please contact the relevant office for details.



M&B

Ground Floor
352 sq.ft. (32.7 sq.m.) approx.

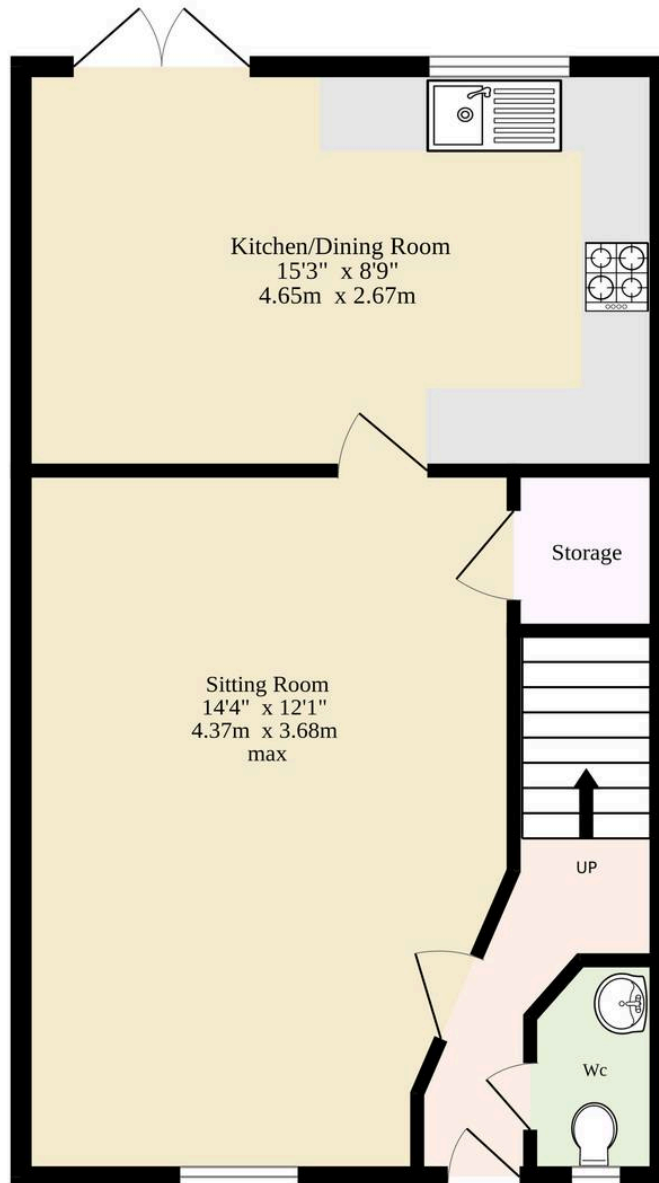

1st Floor
358 sq.ft. (33.3 sq.m.) approx.

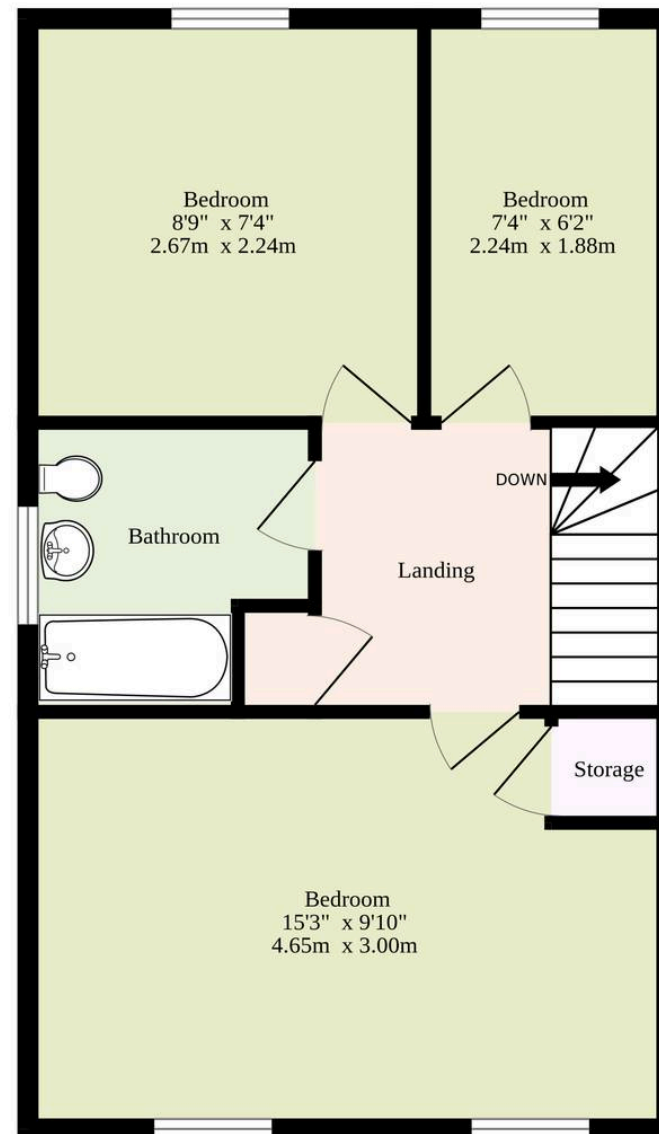

TOTAL FLOOR AREA : 710 sq.ft. (66.0 sq.m.) approx.

Whilst every attempt has been made to ensure the accuracy of the floorplan contained here, measurements of doors, windows, rooms and any other items are approximate and no responsibility is taken for any error, omission or mis-statement. This plan is for illustrative purposes only and should be used as such by any prospective purchaser. The services, systems and appliances shown have not been tested and no guarantee as to their operability or efficiency can be given.
Made with Metropix ©2025

Dreaming of this home? Let's make it a reality



Meet *Sarah*
Senior Property Consultant



Meet *James*
Property Consultant



Meet *Lauren*
Property Consultant

Minors & Brady
Your home, our market

 caister@minorsandbrady.co.uk

 01493 806188

 48 High Street, Caister-on-Sea, Great Yarmouth, NR30 5EH

CAISTER-ON-SEA | DEREHAM | DISS | NORWICH | OULTON BROAD | WROXHAM



How can we support

- ✓ Residential Mortgages
- ✓ Protection & Insurance
- ✓ Buy-to-let (personal and limited company)



Matt Waters
Senior Mortgage
and Protection Advisor



Victoria Payne
Mortgage and
Protection Advisor

Scan to book your
appointment today



T: 01692 531372
E: enquiries@norfolk-mortgages.co.uk