



6 Old Bakery Court, Coltishall

Norwich



Minors & Brady

6 Old Bakery Court

Coltishall, Norwich

A comfortable first-floor flat in the heart of Coltishall, combining convenience with village charm. Bright and open, the kitchen, dining, and living area flows effortlessly, perfect for relaxed evenings or entertaining. The double bedroom offers a quiet retreat, complemented by a practical three-piece bathroom and useful storage in the entrance hall. With one allocated parking space and just moments from village amenities, this home offers a low-maintenance, connected lifestyle in one of Norfolk's most desirable villages.

- First floor flat in the beautiful Norfolk village of Coltishall
- Perfect choice for first time buyers or investors!
- Open-plan kitchen/dining/living room creating an effortless flow for relaxation and entertaining
- Kitchen fitted with wall and base cabinetry, an integrated oven and under-counter areas for your appliances
- A double bedroom offering comfort and privacy
- Bathroom comprising of a classic three-piece suite
- One allocated parking space
- Moments away from village amenities, with a wider range of shops, schools and transport links in Wroxham



M&B



M&B

6 Old Bakery Court

Coltishall, Norwich

Old Bakery Court

Step through the front door into a bright and inviting entrance hall, complete with handy storage, setting the tone for the rest of the home. The open-plan kitchen, dining, and living area creates a seamless flow, perfect for relaxing evenings or entertaining friends and family. The kitchen is thoughtfully fitted with a range of wall and base cabinets, an integrated oven, and under-counter spaces for your appliances, ensuring both style and functionality.

The double bedroom offers comfort and privacy, ready for you to make it your own. The bathroom features a classic three-piece suite, combining practicality with timeless design.

Outside, the property benefits from one allocated parking space, adding ease to your everyday routine.

Agents note

We understand that this property is leasehold.

Please call our Wroxham office for further information.



M&B

Ground Floor
465 sq.ft. (43.2 sq.m.) approx.

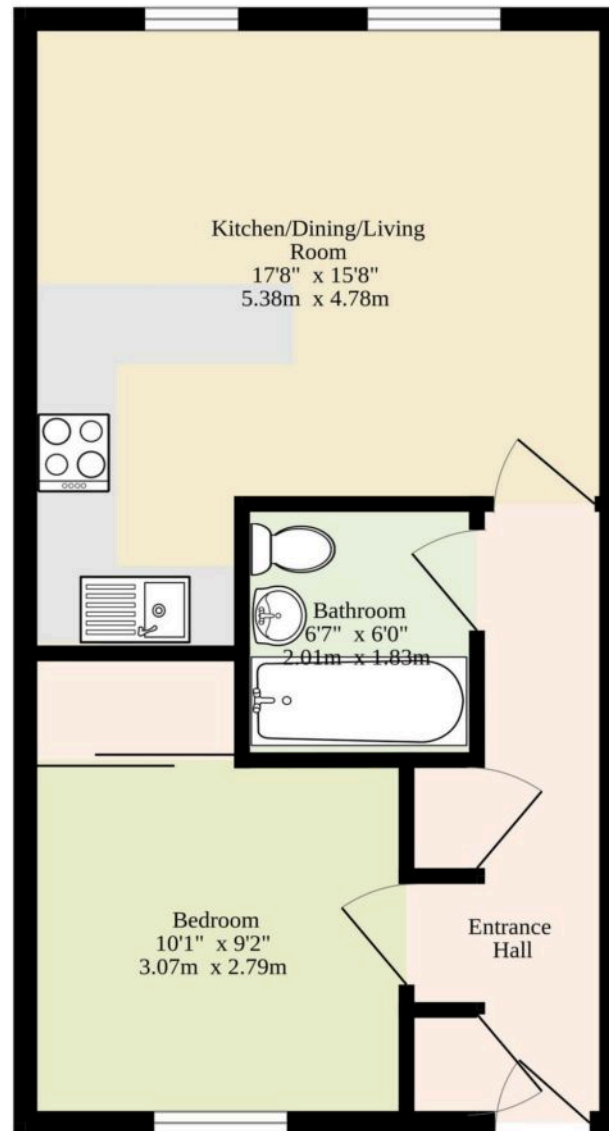

TOTAL FLOOR AREA : 465 sq.ft. (43.2 sq.m.) approx.

Whilst every attempt has been made to ensure the accuracy of the floorplan contained here, measurements of doors, windows, rooms and any other items are approximate and no responsibility is taken for any error, omission or mis-statement. This plan is for illustrative purposes only and should be used as such by any prospective purchaser. The services, systems and appliances shown have not been tested and no guarantee as to their operability or efficiency can be given.

Made with Metropix ©2025

Dreaming of this home? Let's make it a reality



Meet *Abi*
Branch Partner



Meet *Karol*
Property Valuer



Meet *Claire*
Aftersales Team Leader

Minors & Brady
Your home, our market



wroxham@minorsandbrady.co.uk



01603 783088



6 Church Road, Wroxham, Norwich, NR12 8UG

CAISTER-ON-SEA | DEREHAM | DISS | NORWICH | OULTON BROAD | WROXHAM



How can we support

- ✓ Residential Mortgages
- ✓ Protection & Insurance
- ✓ Buy-to-let (personal and limited company)



Matt Waters
Senior Mortgage
and Protection Advisor



Victoria Payne
Mortgage and
Protection Advisor

Scan to book your
appointment today



T: 01692 531372
E: enquiries@norfolk-mortgages.co.uk