



33 North Denes Road, Great Yarmouth

Great Yarmouth

Minors & Brady



£1,500 pcm
Minors & Brady

33 North Denes Road

Great Yarmouth, Great Yarmouth

NO DEPOSIT OPTION Spacious 6-bed, 4-bath terraced house over 3 floors with 2 receptions, modern kitchen, utility, courtyard garden, and no deposit option. Close to Great Yarmouth beach and town centre.

- ***NO DEPOSIT OPTION***
- Six bedroom terraced house arranged over three storeys
- Two reception rooms including lounge, dining area
- Modern kitchen diner with range cooker, integrated appliances and breakfast bar
- Utility room and ground floor cloakroom
- Two bedrooms with en suite shower rooms
- Two family bathrooms, one with both bath and separate shower
- Located in the popular coastal town of Great Yarmouth, close to the sandy beach and open seafront
- Convenient access to the town centre and its range of services
- Available now!



M&B



M&B

Minors & Brady

33 North Denes Road

Great Yarmouth, Great Yarmouth

Council Tax band: C

EPC Energy Efficiency Rating: D

EPC Environmental Impact Rating: E



M&B

33 North Denes Road

Great Yarmouth, Great Yarmouth

NO DEPOSIT OPTION Arranged over three storeys, this substantial six-bedroom terraced house offers generous and flexible accommodation. The ground floor features two reception rooms, including a lounge and dining area. A modern kitchen diner with range cooker, integrated appliances and breakfast bar is supported by a separate utility room and ground floor cloakroom. Across the upper floors are further well-proportioned bedrooms, with two bedrooms benefiting from en suite shower rooms, alongside two family bathrooms, one with both bath and separate shower. Externally, there is a rear courtyard garden and resin finished frontage, all set in the popular coastal town of Great Yarmouth, close to the sandy beach, open seafront and the town centre. Available now!

Location

Positioned in the popular coastal town of Great Yarmouth, North Denes Road enjoys a setting close to the sandy shoreline and wide open seafront. The area is well placed for access to local shops, supermarkets, cafés and everyday amenities, while regular transport links connect you to surrounding villages and the wider Norfolk area. With the beach, dunes and scenic walking routes nearby, this location offers a relaxed coastal lifestyle while still keeping essential services and town centre facilities within easy reach. The nearby North Denes area is known for its open green spaces and access to coastal paths, ideal for morning walks or weekend outings by the sea, and schools and leisure facilities are also within convenient reach, making this a practical yet appealing setting for a range of buyers.

North Denes Road, Great Yarmouth

The property opens into a welcoming hallway with wood-style flooring, leading through to an impressive double reception room. The front reception is the lounge, featuring a bay



Ground Floor
764 sq.ft. (71.0 sq.m.) approx.

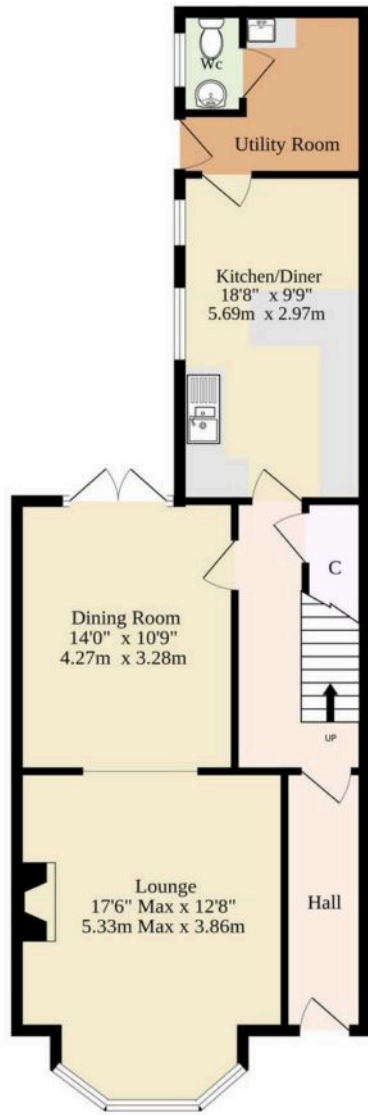

1st Floor
725 sq.ft. (67.4 sq.m.) approx.



2nd Floor
722 sq.ft. (67.1 sq.m.) approx.

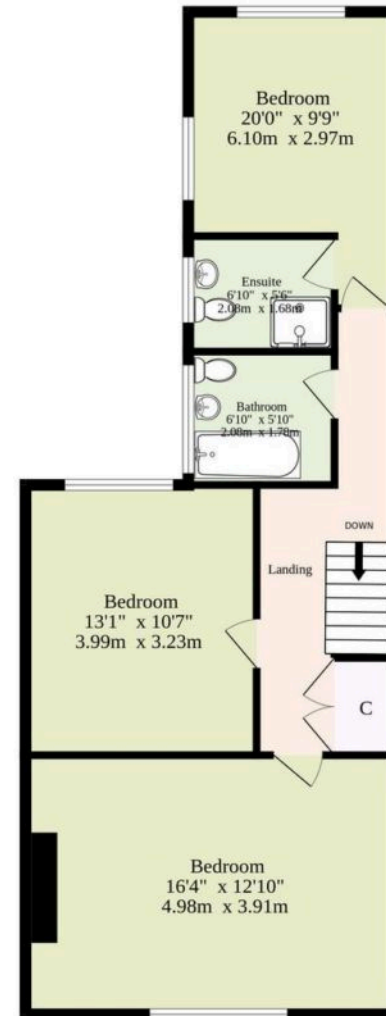

TOTAL FLOOR AREA : 2211 sq.ft. (205.4 sq.m.) approx.

Whilst every attempt has been made to ensure the accuracy of the floorplan contained here, measurements of doors, windows, rooms and any other items are approximate and no responsibility is taken for any error, omission or mis-statement. This plan is for illustrative purposes only and should be used as such by any prospective purchaser. The services, systems and appliances shown have not been tested and no guarantee as to their operability or efficiency can be given.

Made with Metropix ©2026

Dreaming of this home? Let's make it a *reality*



Meet *Sarah*
Senior Property Consultant



Meet *James*
Property Consultant



Meet *Lauren*
Property Consultant

Minors & Brady
Your home, our market

 caister@minorsandbrady.co.uk

 01493 806188

 48 High Street, Caister-on-Sea, Great Yarmouth, NR30 5EH

CAISTER-ON-SEA | DEREHAM | DISS | NORWICH | OULTON BROAD | WROXHAM



How can we support

- ✓ Residential Mortgages
- ✓ Protection & Insurance
- ✓ Buy-to-let (personal and limited company)



Matt Waters
Senior Mortgage
and Protection Advisor



Victoria Payne
Mortgage and
Protection Advisor

Scan to book your
appointment today



T: 01692 531372

E: enquiries@norfolk-mortgages.co.uk