



Plot 35, The Fields, Bacton

Bacton



£330,000
Minors & Brady

Plot 35, The Fields

Bacton

This attractive, newly built three-bedroom semi-detached home forms part of The Fields, an established and fully completed development by Flagship Homes, set within the heart of the Suffolk countryside. Designed with modern living in mind, Plot 35 offers well-proportioned accommodation suited to a range of buyers, including those looking for additional space to grow or work from home. With the development build now complete and strong demand for these properties, this home presents a ready-to-move-in opportunity with flooring included throughout, and is the last remaining home of this design within the scheme.

- Brand new three bedroom semi detached home, offering well proportioned accommodation across two floors
- The final plot of this property style within a fully completed development, ready for immediate occupation and includes flooring
- Spacious kitchen and dining room providing a practical layout with direct access to the garden
- Separate, well proportioned lounge creating a comfortable and private living space
- Principal bedroom with ensuite shower room with two further bedrooms offering flexibility for family living, guests or home working
- Thoughtfully designed layout suited to modern day living
- Allocated off road parking providing ease and convenience for residents
- NHBC 10 year warranty from build completion, offering peace of mind for buyers



M&B



M&B

Plot 35, The Fields

Bacton

Council Tax band: TBD

Tenure: Freehold



M&B

Plot 35, The Fields

Bacton

This attractive, newly built three-bedroom semi-detached home forms part of The Fields, an established and fully completed development by Flagship Homes, set within the heart of the Suffolk countryside. Designed with modern living in mind, Plot 35 offers well-proportioned accommodation suited to a range of buyers, including those looking for additional space to grow or work from home. With the development build now complete and strong demand for these properties, this home presents a ready-to-move-in opportunity with flooring included throughout, and is the last remaining home of this design within the scheme.

Location

The Fields is positioned along Turkey Hall Lane within the established village of Bacton, an area recognised for its community spirit and relaxed rural setting. The village supports day-to-day living with a primary school, village hall, church, and local facilities, while regular events throughout the year create a welcoming and sociable atmosphere. Surrounded by open countryside, the area offers excellent opportunities for walking, cycling, and enjoying Suffolk's landscapes, with quiet lanes and public footpaths close by.

The nearby market town of Stowmarket provides a wider selection of supermarkets, independent shops, cafes, and leisure facilities, along with a mainline railway station offering direct services to Ipswich, Norwich, and London Liverpool Street. Road links are also convenient, with access to the A14 connecting easily to the wider region. This setting suits those looking for a village lifestyle with strong connections to surrounding towns and transport routes.

The Fields **M&B**

Enter the home into the hall, you'll find the ground floor offers a well planned layout with a spacious kitchen and dining room positioned to the rear providing a practical and



Ground Floor

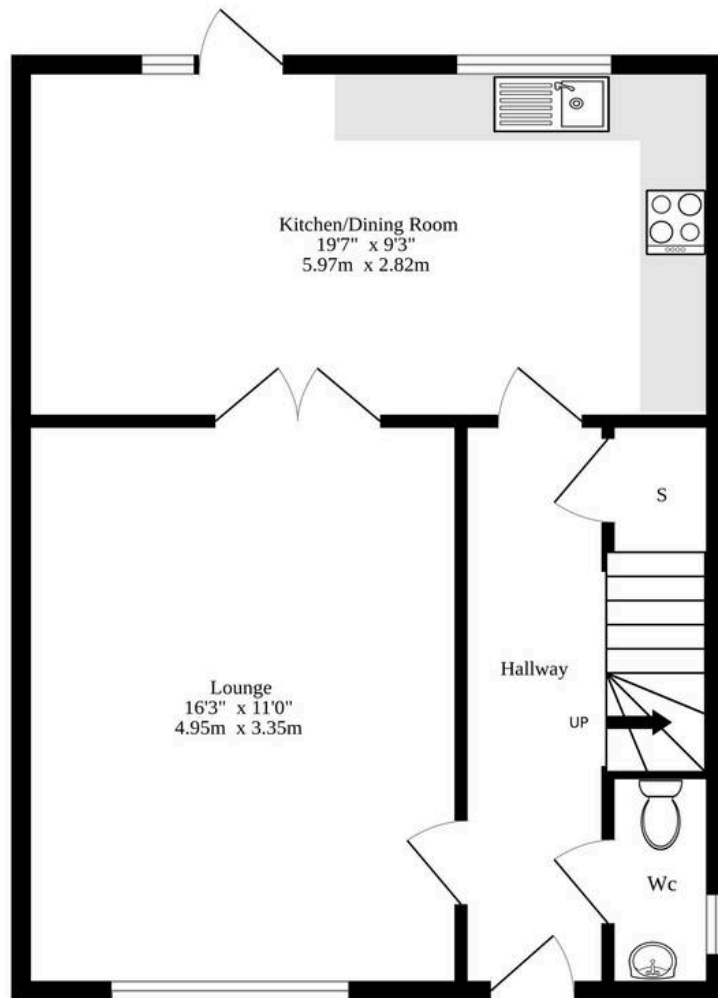

1st Floor

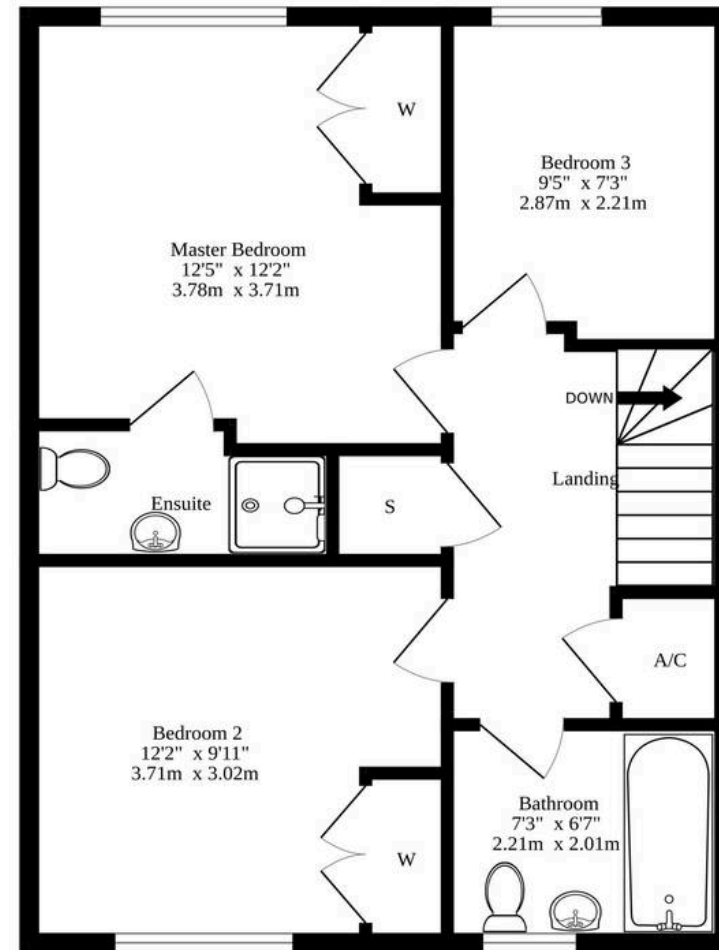

TOTAL FLOOR AREA : 1001sq.ft. (93.0 sq.m.) approx.

Whilst every attempt has been made to ensure the accuracy of the floorplan contained here, measurements of doors, windows, rooms and any other items are approximate and no responsibility is taken for any error, omission or mis-statement. This plan is for illustrative purposes only and should be used as such by any prospective purchaser. The services, systems and appliances shown have not been tested and no guarantee as to their operability or efficiency can be given.
 Made with Metropix ©2026

Dreaming of this home? Let's make it a reality



Meet *Nicola*
Branch Manager



Meet *Theo*
Property Consultant



Meet *Anya*
Aftersales Progressor

Minors & Brady
Your home, our market

 diss@minorsandbrady.co.uk

 01379 771444

 46-47 Mere Street, Diss, IP22 4AG

CAISTER-ON-SEA | DEREHAM | DISS | NORWICH | OULTON BROAD | WROXHAM



How can we support

- ✓ Residential Mortgages
- ✓ Protection & Insurance
- ✓ Buy-to-let (personal and limited company)



Matt Waters
Director and
Principal



Victoria Payne
Mortgage and
Protection Advisor

Offering you quick and professional mortgage advice every step of the way.

T: 01603 210378
E: enquiries@norfolk-mortgages.co.uk