



24 Taylors Loke, Hemsby

Great Yarmouth



Minors & Brady

24 Taylors Loke

Hemsby, Great Yarmouth

Set within the coastal village of Hemsby, this charming cottage offers a characterful interior dating back to 1782, paired with practical living spaces, making it an appealing choice for those seeking a coastal retreat, holiday let, or investment opportunity. With a newly completed thatched roof in November 2025 and a range of thoughtful features throughout, the property presents a ready-to-enjoy home with both comfort and individuality.

Offered furnished, it provides an easy transition for buyers looking for a turnkey purchase. The overall setting enhances its appeal, placing you within easy reach of the beach and local village amenities. This is a home that combines traditional character with everyday usability in a sought-after coastal location.



24 Taylors Loke

Hemsby, Great Yarmouth

- Charming cottage style home with character features throughout, ideal as a holiday let or coastal retreat
- Brand new thatched roof completed in November 2025, offering both visual appeal and long term peace of mind
- Spacious lounge featuring a striking brick inglenook fireplace with tiled hearth and a 10.5kW multi fuel burner
- Double skinned wrapped flexible flue liner chimney, enhancing efficiency and performance of the heating system
- Bright conservatory providing additional living space, perfect as a sun room or dining area overlooking the garden
- Well proportioned kitchen with practical layout and direct access to the rear of the property
- Generous double bedroom to the first floor with additional eaves storage
- Attractive garden with a post lit patio area, creating an inviting space for outdoor seating and evening use
- Single storey brick built outhouse offering useful storage or potential for a variety of uses
- Offered furnished, making it a ready to move into or turnkey investment opportunity

Council Tax band: B

Tenure: Freehold

EPC Energy Efficiency Rating: D

EPC Environmental Impact Rating: E



M&B

24 Taylors Loke

Hemsby, Great Yarmouth

Location

Situated within a residential area of Hemsby, Taylors Loke offers a convenient coastal setting with easy access to the village's amenities. Hemsby is well known for its sandy beach and seafront attractions, along with a range of local shops, cafés, and everyday essentials. The village also benefits from a primary school and regular transport links to surrounding areas.

Nearby Great Yarmouth provides a wider selection of supermarkets, retail outlets, leisure facilities, and healthcare services, while the surrounding coastline and countryside offer a variety of walking routes and outdoor spaces to enjoy throughout the year. This location provides a practical base close to both coastal and town amenities.

Taylors Loke

Stepping inside, the property is accessed via the kitchen or conservatory, both providing a practical and welcoming entry into the home. The kitchen is well arranged with a functional layout, offering a range of units and worktop space suited to everyday use. Alternatively, the conservatory provides a bright entrance point that can also serve as a dining or seating area, enjoying views over the garden and creating a natural extension of the living space.



24 Taylors Loke

Hemsby, Great Yarmouth

From here, the accommodation flows through to the spacious lounge, a room that immediately showcases the character of the property. Centred around a striking brick inglenook fireplace with a tiled hearth, this space features a 10.5kW multi fuel burner supported by a double skinned wrapped flexible flue liner chimney, creating an efficient and cosy focal point. The room offers ample space for both relaxing and entertaining, with a warm and inviting atmosphere. The ground floor is completed by a bathroom fitted with a suite designed for everyday convenience.

Upstairs, the first floor is dedicated to a generous bedroom, offering comfortable proportions along with access to eaves storage, adding useful practicality without compromising on space.

Externally, the garden has been designed for ease of use while still providing an attractive outdoor setting. A post lit patio area creates an inviting space for seating and evening enjoyment, while the remainder of the garden offers scope for planting or further personalisation. A single storey brick built outhouse provides additional storage or potential for a variety of uses.



Ground Floor

Approx. 48.0 sq. metres (516.7 sq. feet)

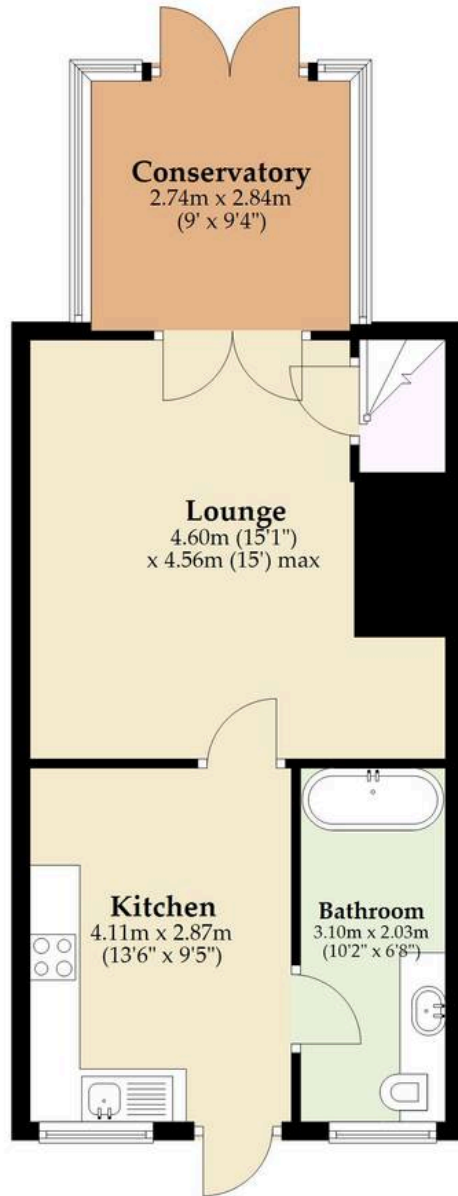

First Floor

Approx. 29.3 sq. metres (315.4 sq. feet)



Total area: approx. 77.3 sq. metres (832.2 sq. feet)

Whilst every attempt has been made to ensure the accuracy of the floorplan contained here, measurements of doors, windows, rooms and any other items are approximate and no responsibility is taken for any error, omission or mis-statement. This plan is for illustrative purposes only and should be used as such by any prospective purchaser.

The services, systems and appliances shown have not been tested and no guarantee as to their operability or efficiency can be given.

Plan produced using PlanUp.

Dreaming of this home? Let's make it a *reality*.



Meet *Sarah*
Senior Property Consultant



Meet *Dan*
Branch Partner



Meet *Lauren*
Property Consultant

Minors & Brady
Your home, our market

 caister@minorsandbrady.co.uk

 01493 806188

 48 High Street, Caister-on-Sea, Great Yarmouth, NR30 5EH

CAISTER-ON-SEA | DEREHAM | DISS | NORWICH | OULTON BROAD | WROXHAM



How can we support

- ✓ Residential Mortgages
- ✓ Protection & Insurance
- ✓ Buy-to-let (personal and limited company)



Matt Waters
Director and
Principal



Victoria Payne
Mortgage and
Protection Advisor

Offering you quick and professional mortgage advice every step of the way.

T: 01603 210378
E: enquiries@norfolk-mortgages.co.uk