



54 Orchard Close, North Elmham

Dereham



In Excess of £230,000
Minors & Brady

54 Orchard Close

North Elmham, Dereham

Guide price £220,000 - £240,000. Two bedroom semi-detached family home located in the peaceful village of North Elmham, offering a variety of amenitie...



M&B



M&B

Minors & Brady

54 Orchard Close

North Elmham, Dereham

Council Tax band: B

Tenure: Freehold

EPC Energy Efficiency Rating: E

EPC Environmental Impact Rating: F



M&B



54 Orchard Close

North Elmham, Dereham

Guide price £220,000 - £240,000. Two bedroom semi-detached family home located in the peaceful village of North Elmham, offering a variety of amenities within. This immaculate home boasts a welcoming lounge, open plan fitted kitchen and diner, conservatory with garden views, three piece family bathroom, two generous sized bedrooms, low maintenance frontage with off road parking and a private rear garden with an area ideal for alfresco dining.

Guide price £220,000 - £240,000. Two bedroom semi-detached family home located in the peaceful village of North Elmham, offering a variety of amenities within. This immaculate home boasts a welcoming lounge, open plan fitted kitchen and diner, conservatory with garden views, three piece family bathroom, two generous sized bedrooms, low maintenance frontage with off road parking and a private rear garden with an area ideal for alfresco dining.

Council Tax band: B

Tenure: Freehold

EPC Energy Efficiency Rating: E

EPC Environmental Impact Rating: F



M&B

GROUND FLOOR

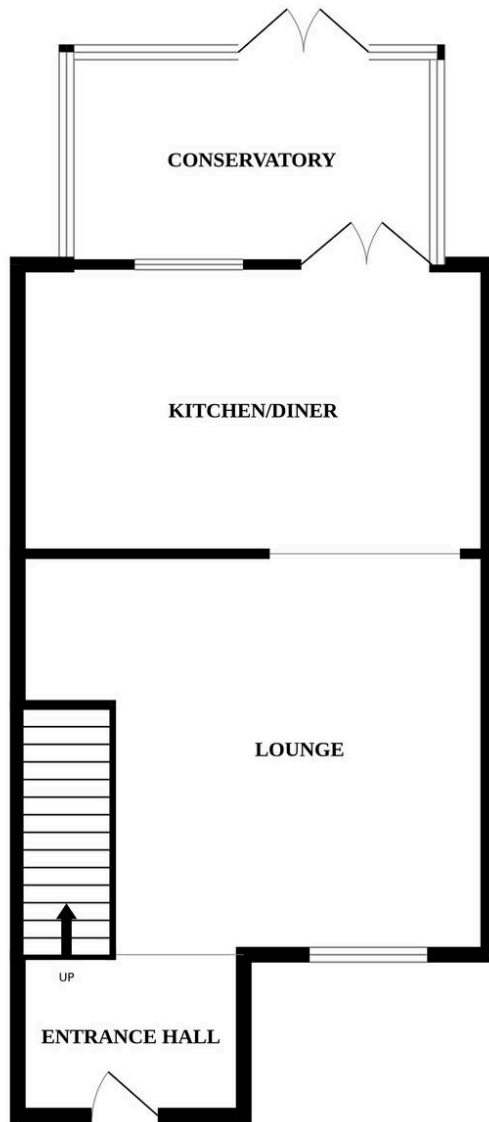

1ST FLOOR

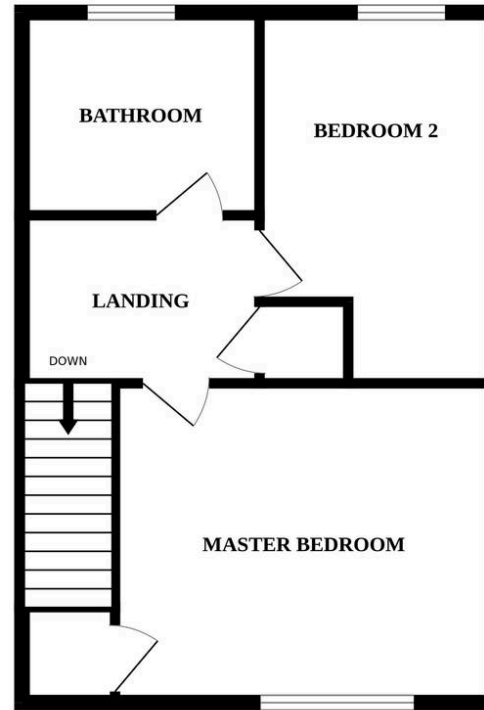

Dreaming of this home? Let's make it a *reality*.



Meet *Kyle*
Branch Manager



Meet *Aysegul*
Aftersales Progressor



Meet *Curtis*
Listings Director

Minors & Brady
Your home, our market



dereham@minorsandbrady.co.uk



01362 700820



9a Market Place, Dereham, NR19 2AW

BURY ST. EDMUNDS | CAISTER-ON-SEA | DEREHAM | DISS | NORWICH | OULTON BROAD | WROXHAM



How can we support

- ✓ Residential Mortgages
- ✓ Protection & Insurance
- ✓ Buy-to-let (personal and limited company)



Matt Waters
Director and
Principal



Victoria Payne
Mortgage and
Protection Advisor

Offering you quick and professional mortgage advice every step of the way.

T: 01603 210378
E: enquiries@norfolk-mortgages.co.uk