



6 Hewetson Close, Salhouse

Guide Price £1,000,000

6 Hewetson Close

Salhouse, Norwich

Defined by its exceptional specification and truly one-of-a-kind design, this outstanding home on Hewetson Close offers a rare opportunity to own something entirely unique. Designed as a bespoke build, the property delivers beautifully bright interiors, with expansive glazing and a seamless flow between living spaces and the garden. The heart of the home is a stunning, high-spec kitchen complete with premium appliances and a central island, perfectly suited to both everyday living and entertaining. Across three floors, five generous double bedrooms are complemented by three luxurious en-suites, including an impressive principal suite with dressing space. Outside, the landscaped garden, porcelain terrace and generous driveway enhance both lifestyle and practicality. Combining cutting-edge features, refined finishes and a peaceful setting, this is a truly standout home in a sought-after location.

Council Tax band: F

Tenure: Freehold

EPC Energy Efficiency Rating: A

EPC Environmental Impact Rating: B





6 Hewetson Close

Salhouse, Norwich

Defined by its exceptional specification and truly one-of-a-kind design, this outstanding home on Hewetson Close offers a rare opportunity to own something entirely unique. Designed as a bespoke build, the property delivers beautifully bright interiors, with expansive glazing and a seamless flow between living spaces and the garden. The heart of the home is a stunning, high-spec kitchen complete with premium appliances and a central island, perfectly suited to both everyday living and entertaining. Across three floors, five generous double bedrooms are complemented by three luxurious en-suites, including an impressive principal suite with dressing space. Outside, the landscaped garden, porcelain terrace and generous driveway enhance both lifestyle and practicality. Combining cutting-edge features, refined finishes and a peaceful setting, this is a truly standout home in a sought-after location.

Salhouse Living — A Perfect Balance of Countryside Charm, Community and Connectivity

Placed within the highly sought-after village of Salhouse, this home enjoys a setting that perfectly reflects everything people love about Norfolk Broads living. Known for its strong community feel and picturesque surroundings, Salhouse has long been considered one of the area's most desirable villages, offering a lifestyle that feels both relaxed and well-connected.

One of the aspects the current owners have particularly enjoyed is just how convenient yet peaceful the location feels. With Salhouse train station within easy reach, providing direct links



Ground Floor
Approx. 136.2 sq. metres (1466.0 sq. feet)



First Floor
Approx. 125.1 sq. metres (1346.4 sq. feet)



Second Floor
Approx. 59.4 sq. metres (639.1 sq. feet)

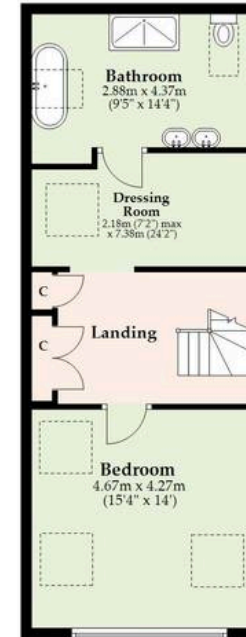

Total area: approx. 320.7 sq. metres (3451.5 sq. feet)

Whilst every attempt has been made to ensure the accuracy of the floorplan contained here, measurements of doors, windows, rooms and any other items are approximate and no responsibility is taken for any error, omission or mis-statement. This plan is for illustrative purposes only and should be used as such by any prospective purchaser. The services, systems and appliances shown have not been tested and no guarantee as to their operability or efficiency can be given.
Plan produced using Plan!p.

