



12 Randall Close, Hopton

Great Yarmouth



Minors & Brady

12 Randall Close

Hopton, Great Yarmouth

Moments from the coastline and set within a peaceful cul-de-sac, this well-presented semi-detached home offers an easy, relaxed way of living in the heart of Hopton-on-Sea. Thoughtfully updated with brand-new double-glazed windows and doors in 2025, it features a welcoming entrance hall, a modern kitchen/dining room, a light-filled living space that opens into the conservatory, and three comfortable bedrooms served by a contemporary shower room. A private rear garden, driveway parking and a single garage complete the picture, making this an appealing choice for first-time buyers, small families or investors seeking a coastal home that's ready to enjoy.



M&B



M&B

12 Randall Close

Hopton, Great Yarmouth

- Semi-detached residence positioned down a quiet cul-de-sac in the coastal village of Hopton-On-Sea
- Suitable choice for first-time buyers, small families or investors, looking for well-presented accommodation
- Brand-new double glazed windows and doors installed in 2025
- Kitchen/dining room equipped with modern cabinetry, an integrated oven and areas for your own appliances
- Spacious living room with a full-length window and internal French doors that opens into the conservatory, that extends the reception space and offers views of the garden
- Three bedrooms offering the utmost comfort and privacy, along with a shower room comprising of a contemporary three-piece suite
- A private, well-maintained garden featuring a patio for outdoor seating, a laid to lawn and established beds
- A driveway providing off-road parking and a single garage for storage use
- Easy access to amenities within the village, including essential shops, schools, healthcare facilities the scenic coastline

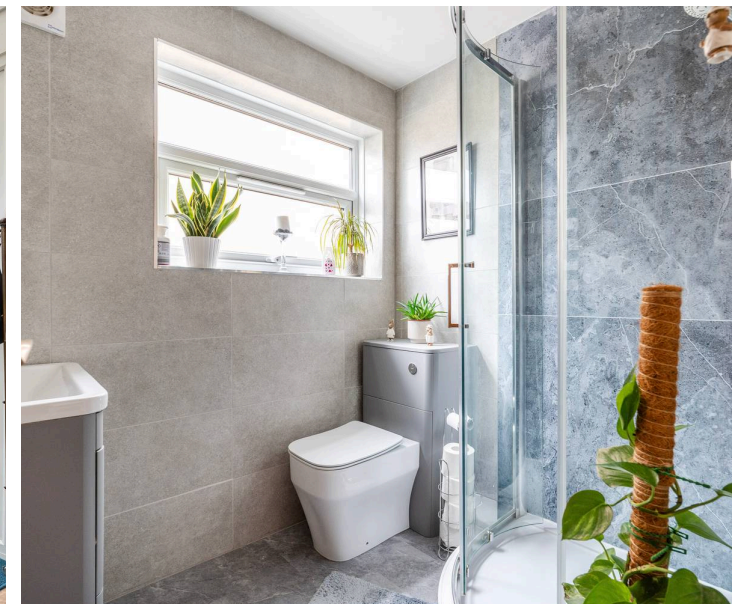

M&B

12 Randall Close

Hopton, Great Yarmouth

Hopton-On-Sea

Randell Close sits in a quiet residential pocket of Hopton-on-Sea, a coastal village on the Norfolk–Suffolk border. The setting is suburban and peaceful, with cul-de-sacs and green pockets typical of the area, and it's only a short walk from the wide sandy beach that defines the village's coastline. Hopton's amenities cluster around the village centre: everyday needs are covered by local shops, cafés, takeaways, a pharmacy, and the well-used village hall. Larger supermarkets are close by, Tesco Superstore in Great Yarmouth (Caister Road) and Morrisons in Gorleston are the nearest full-range options, both within a short drive.

Families benefit from nearby schools, including Hopton Church of England Primary Academy within the village and Ormiston Venture Academy and Cliff Park Ormiston Academy in Gorleston for secondary education. Transport links are practical for a coastal village: regular bus services run towards Great Yarmouth and Lowestoft, connecting to wider rail networks, while the A47 provides straightforward road access for commuting or weekend trips. The overall lifestyle here is relaxed and outdoors-leaning, beach walks, coastal cycling routes, and easy access to both seaside towns make it a location that balances calm residential living with convenient amenities and good connectivity.



12 Randall Close

Hopton, Great Yarmouth

A well-presented semi-detached residence set along a quiet cul-de-sac in the coastal village of Hopton-on-Sea, this home offers an inviting setting for first-time buyers, small families or investors seeking a comfortable property close to the shoreline.

The entrance hall creates an immediate sense of ease, leading into interiors that have been thoughtfully maintained. Recent upgrades include brand-new double-glazed windows and doors installed in 2025, enhancing both comfort and efficiency. The kitchen/dining room features modern cabinetry, an integrated oven and space for your own appliances, with an under-stairs cupboard providing practical storage.

The living room enjoys a full-length window that draws in generous natural light. Internal French doors open into the conservatory, creating an extended reception area ideal for relaxing, entertaining or simply enjoying views of the garden. Additional French doors lead directly outside, encouraging a gentle connection between indoor and outdoor spaces.

Upstairs, three bedrooms offer comfort and privacy for all household members. The shower room is fitted with a contemporary three-piece suite, including a shower cubicle, hand basin and toilet, giving the home a clean and modern finish.



M&B

12 Randall Close

Hopton, Great Yarmouth

The rear garden is private and well maintained, featuring a patio for outdoor seating, a lawn for everyday use and established beds that bring colour and interest throughout the seasons.

A driveway provides off-road parking, complemented by a single garage ideal for storage or hobby use.

A bright and welcoming semi-detached home offering modern comforts, versatile living spaces and a private garden, all set within a peaceful cul-de-sac in a desirable coastal village. A property that feels ready to move into and simple to make your own.

Agents Notes

Freehold

Connected to mains water, electricity, gas and drainage.

Gas central heating.



Energy Efficiency Rating		Current	Potential
<i>Very energy efficient - lower running costs</i>			
(92+)	A		
(81-91)	B		
(69-80)	C		80
(55-68)	D	64	
(39-54)	E		
(21-38)	F		
(1-20)	G		
<i>Not energy efficient - higher running costs</i>			
England, Scotland & Wales		EU Directive 2002/91/EC	

Ground Floor

Approx. 53.4 sq. metres (575.1 sq. feet)

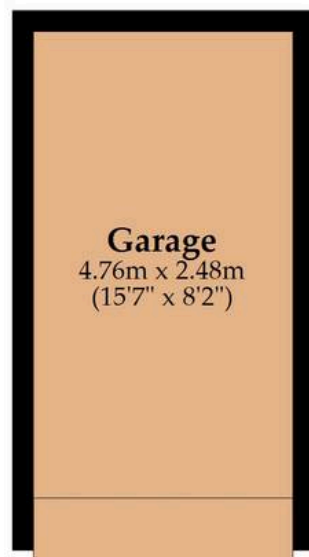
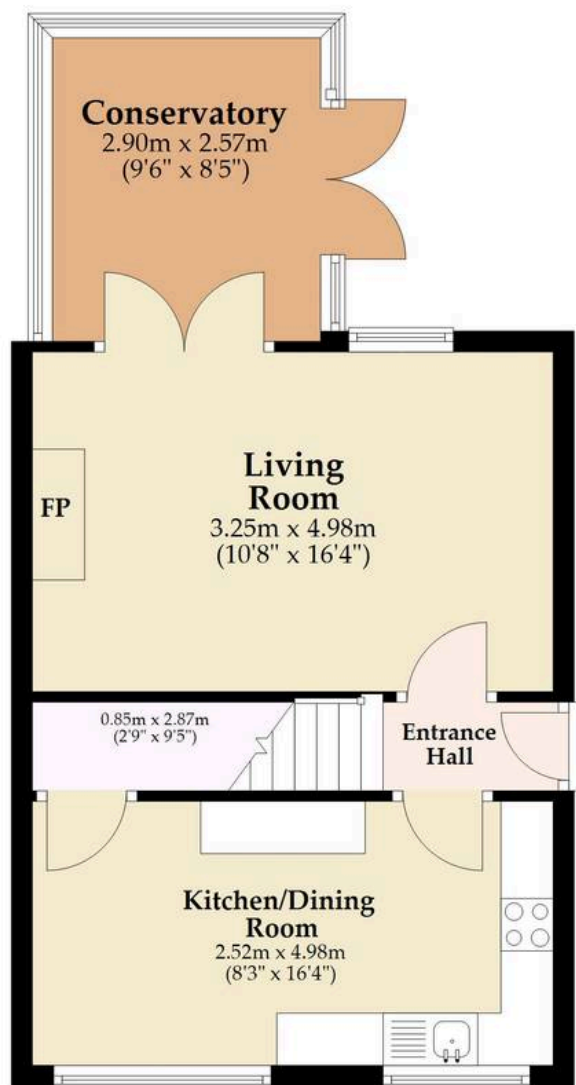

First Floor

Approx. 35.0 sq. metres (376.8 sq. feet)

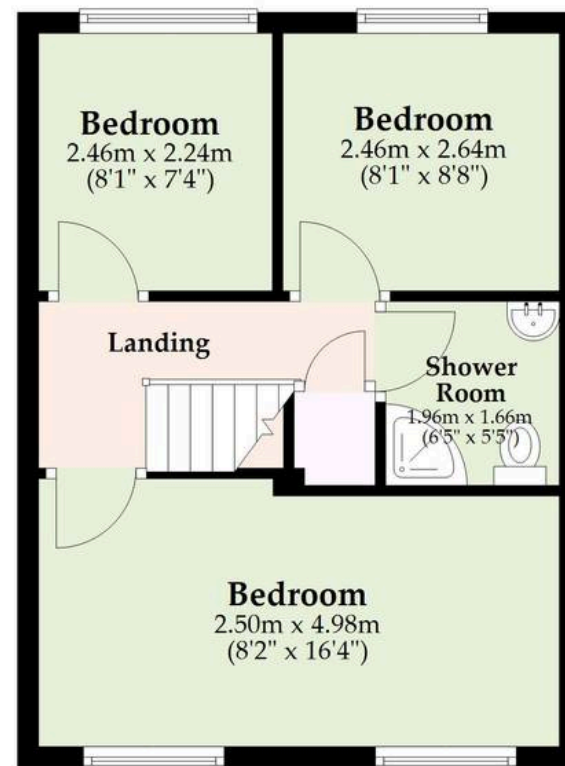

Total area: approx. 88.4 sq. metres (951.9 sq. feet)

Whilst every attempt has been made to ensure the accuracy of the floorplan contained here, measurements of doors, windows, rooms and any other items are approximate and no responsibility is taken for any error, omission or mis-statement. This plan is for illustrative purposes only and should be used as such by any prospective purchaser. The services, systems and appliances shown have not been tested and no guarantee as to their operability or efficiency can be given.

Plan produced using PlanUp.

Dreaming of this home?
Let's make it a *reality*.



Meet *Sarah*
Senior Property Consultant



Meet *Dan*
Branch Partner



Meet *Lauren*
Property Consultant

Minors & Brady
Your home, our market

 caister@minorsandbrady.co.uk

 01493 806188

 48 High Street, Caister-on-Sea, Great Yarmouth, NR30 5EH

BURY ST. EDMUNDS | CAISTER-ON-SEA | DEREHAM | DISS | NORWICH | OULTON BROAD | WROXHAM



How can we support

- ✓ Residential Mortgages
- ✓ Protection & Insurance
- ✓ Buy-to-let (personal and limited company)



Matt Waters
Director and
Principal



Victoria Payne
Mortgage and
Protection Advisor

Offering you quick and professional mortgage advice every step of the way.

T: 01603 210378
E: enquiries@norfolk-mortgages.co.uk